

CONTACT LAYOUT

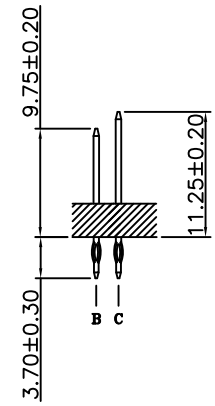

Material:

Housing: 30% Glass Filled PBT UL94V-0.
 Contacts: Phosphor Bronze.

Electrical Characteristics:

Current Rating: 1 AMP.
 Dielectric Withstanding Voltage: AC 750V For 1 minute.
 Insulator Resistance: 10000MΩ min.at DC 500V.
 Contact Resistance: 20mΩ max.at DC 100mA.
 Operating Temperature: -55°C ~ +105°C .

***RoHS Compliant**

RoHS Compliant

TOLERANCES ARE



煜倫股份有限公司

www.morethanall.com

DRAWING BY CY
 CHECKED BY GENIUS
 UNIT / mm SCALE 1 : 1
 DATE
 SIZE A4 PPROJECTION

X. ±
 .X ±
 .XX ±
 .XXX ±
 ANG ±

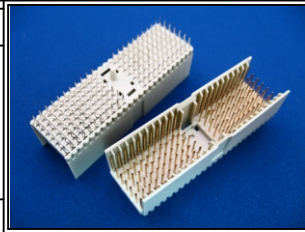

ORDER INFORMATION

HM7A-PP03BC-154-LF
 SERIES | BC TYPE | 154 WAX | LEADFREE
 3.7mm | PRESS FIT
 MALE

DESCRIPTION: