

**Material:**

Housing: 30% Glass filled PBT UL94V-0.  
 Contacts: Phosphor Bronze.  
 Coaxial or Power: Cu Alloy.

**Electrical Characteristics:**

Current Rating: 2 AMP.  
 Dielectric Withstanding Voltage: AC 1000V For 1 minute.  
 Insulator Resistance: 1000MΩ min. at DC 500V.  
 Contact Resistance: 30mΩ max. at DC 100mA.  
 Operating Temperature: -55°C ~ +105°C .

**\* RoHS Compliant**

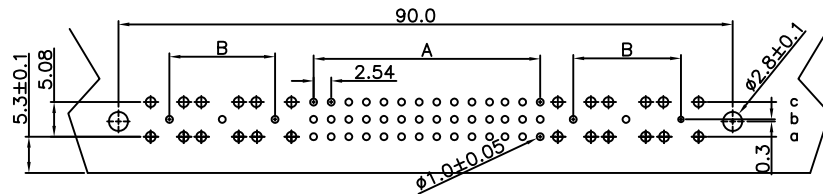
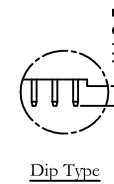
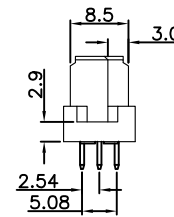
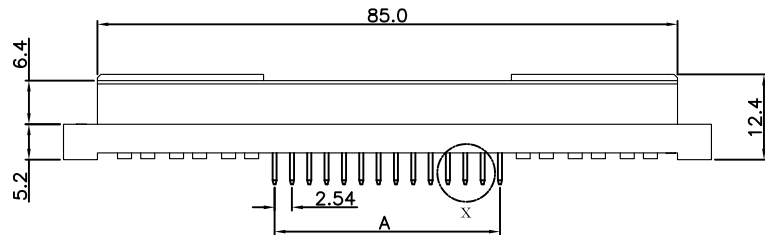

P.C. Board Layout (Coaxial)

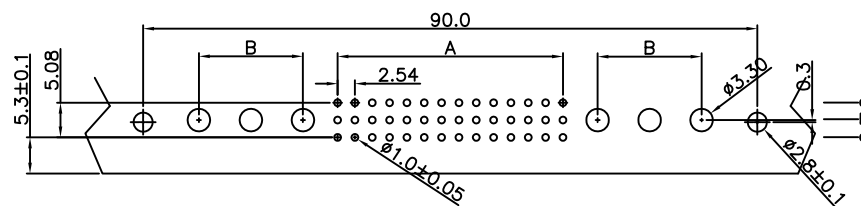

P.C. Board Layout (Power)

Length	1	2	W1	W2
X	4.0	2.5	13	17
Dimension				
A	(2.54 x No of Contact) / 3-2.54			
B	(7.62 x No of Coaxial) / 2-7.62			
Pitch	Position	Rows with Contacts	Contact Arrange	With Coaxial Or Power
2.54mm	78	a b c		2 Pcs
	60	a b c		4 Pcs
	42	a b c		6 Pcs
	24	a b c		8 Pcs
	6	a b c		10 Pcs
	52	a - c		2 Pcs
	40	a - c		4 Pcs
	28	a - c		6 Pcs
	16	a - c		8 Pcs
	4	a - c		10 Pcs

**RoHS Compliant**

TOLERANCES ARE



煜倫股份有限公司

www.morethanall.com

DRAWING BY CY  
 CHECKED BY GENIUS  
 UNIT / mm SCALE 1 : 1  
 DATE  
 SIZE A4 PPROJECTION

X, ±  
 .X ±  
 .XX ±  
 .XXX ±  
 ANG ±

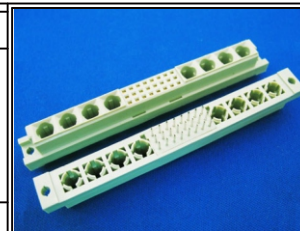

**ORDER INFORMATION**

UM-SDxx-xx+x-LF  
 SERIES LEADFREE  
 04+10  
 78+2  
 FEMALE 04~17mm LENGTH  
 DIP 180°

DESCRIPTION: