

Specifications:

Current rating:1.0A AC/DC
 Voltage rating:50V AC/DC
 Contact resistance:20m ohm max.
 Insulation Resistance:1,000M ohm min.
 Withstanding voltage:500V AC/minute
 Temperature range:-25°C to +105°C

Material:

Insulator:LCP (UL94V-0)
 Insulator Color:Black
 Contact:Phosphor Bronze
 Plating:Gold/Tin/Selective Gold Plated

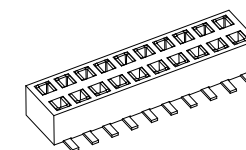
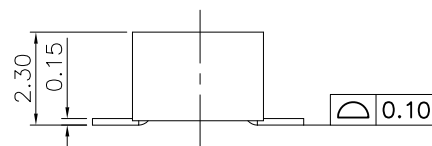
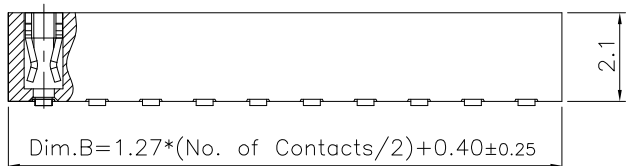

Dimension :

Pin No.	Dim A	Dim B	Pin No.	Dim A	Dim B	Pin No.	Dim A	Dim B	Pin No.	Dim A	Dim B
04	1.27	2.94	24	13.97	15.64	44	26.67	28.34	64	39.37	41.04
06	2.54	4.21	26	15.24	16.91	46	27.94	29.61	66	40.64	42.31
08	3.81	5.48	28	16.51	18.18	48	29.21	30.88	68	41.91	43.58
10	5.08	6.75	30	17.78	19.45	50	30.48	32.15	70	43.18	44.85
12	6.35	8.02	32	19.05	20.72	52	31.75	33.42	72	44.45	46.12
14	7.62	9.29	34	20.32	21.99	54	33.02	34.69	74	45.72	47.39
16	8.89	10.56	36	21.59	23.26	56	34.29	35.96	76	46.99	48.66
18	10.16	11.83	38	22.86	24.53	58	35.56	37.23	78	48.26	49.93
20	11.43	13.10	40	24.13	25.80	60	36.83	38.50	80	49.53	51.20
22	12.70	14.37	42	25.40	27.07	62	38.10	39.77			

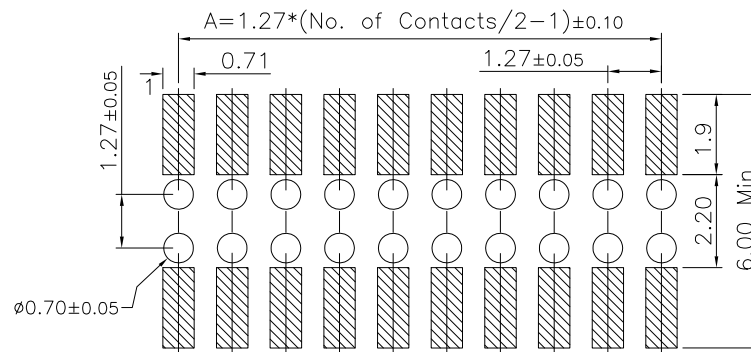

P.C.B Layout

RoHS Compliant

TOLERANCES ARE



煜倫股份有限公司

www.morethanall.com

DRAWING BY CY

CHECKED BY GENIUS

UNIT/mm SCALE 1:1

DATE

SIZE A4

PJECTION

X.±
 .X±
 .XX±
 .XXX±
 ANG±

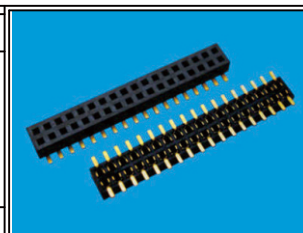

ORDER INFORMATION

YA-Z23X-2Xxx-LF

SERIES
 LEADFREE
 2X02:04WAY
 2X40:80WAY
 NON POST
 HIGH 2.3mm
 BOTTOM ENTRY SMT

DESCRIPTION: