

OPERATION FORCE	
L	100±50g
H	180±50g (std.) (Click sound)

LAYOUT

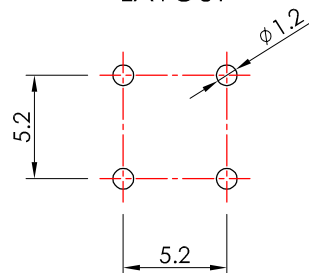

SCHEMATIC

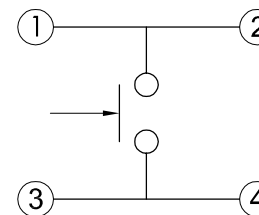

CAP COLOR	
BK	Black
GE	Gray
BL	Blue
RD	Red
YL	Yellow
GR	Green
OR	Orange

SPECIFICATION

Circuit: PUSH (ON).
Rating: 1A 125V AC.
Insulation resistance: 100MΩ for 500V DC .
Contact resistance: 30mΩ for 1A 5V DC .
Life cycles: 100,000 Cycles.
Withstand voltage: AC 500V 1 minute.
Operating force: 180±50g.
Soldering: 245°C Max for 3 Sec.

MATERIAL

Cover: PC.
Base: Nylon 66 + Glass fiber.
Spring: Stainless steel, heat treatment.
Spring piece: Stainless steel, heat treatment.
End contact: Bronze, gold plated.
End terminal: Carbon-steel, gold plated.

RoHS Compliant

TOLERANCES ARE

MORETHANALL
 PCB CONNECTORS
 Cable ASSEMBLIES

煜倫股份有限公司

www.morethanall.com

DRAWING BY CY

CHECKED BY GENIUS

UNIT / mm SCALE 1 : 1

DATE

SIZE A4

X.±
 .X±
 .XX±
 .XXX±
 ANG±

PJECTION

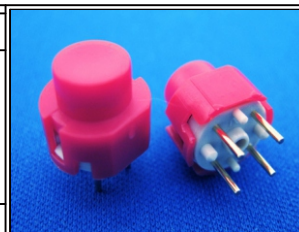

ORDER INFORMATION

KBSW-DR43xx-xxx-LF
 SERIES | | | LEADFREE
 100:100g
 180:180g
 BK:BLACK
 OR:ORANGE
 4.3mm

DESCRIPTION: