

A-A SECTION

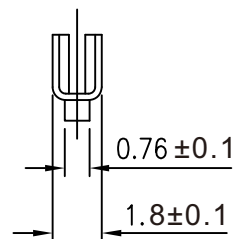
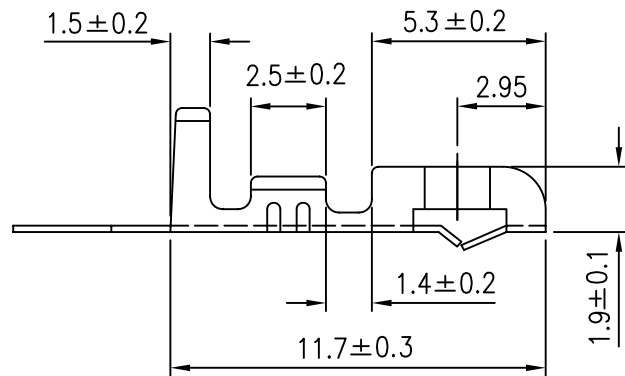

B-B SECTION

■ **TERMINAL**

- Material: Brass
- Thickness: 0.2mm
- Plating: Tin plated
- Wire Range: Suitable for AWG#22~26
- Insulation O.D: 1.75mm (max)
- Q'TY: 10,000 pcs/roll

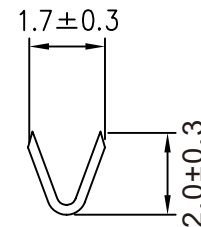

RoHS Compliant

TOLERANCES ARE

MORETHANALL
PCB CONNECTORS
Cable ASSEMBLIES

DRAWING BY CY

CHECKED BY GENIUS

UNIT / mm

SCALE 1 : 1

DATE

SIZE A4

PPOJECTION

X.±
.X±
.XX±
.XXX±
ANG±

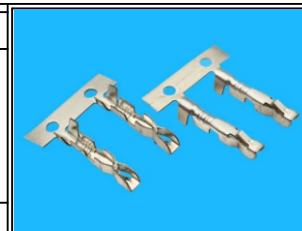

ORDER INFORMATION

EI-T-22-LF
SERIES | LEADFREE
22~26AWG
TERMINAL

煜倫股份有限公司

www.morethanall.com

DESCRIPTION: EI SERIES 2.54mm Pitch Terminal