

RECOMMENDED P.C.BOARD HOLE DIMM.

## SPECIFICATIONS

### Electrical

Current Rating: 5A AC, DC

Voltage Rating: 250V AC, DC

Operating Temp.: -25°C ~ +85°C

Insulation Resistance: 1000MΩ/ min.

Dielectric Withstanding Voltage: 1500V AC/ min.

Contact Resistance: 10mΩ/ max.

### Material

Material: Nylon66, UL94V-2

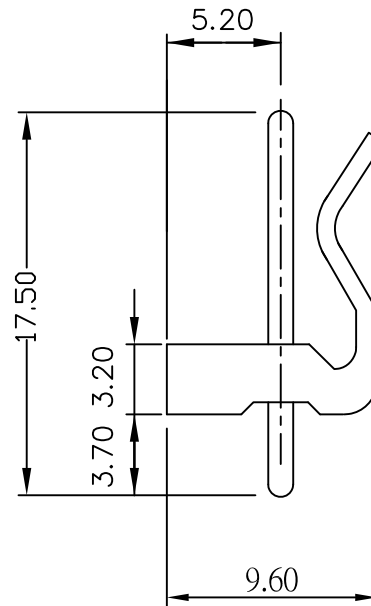
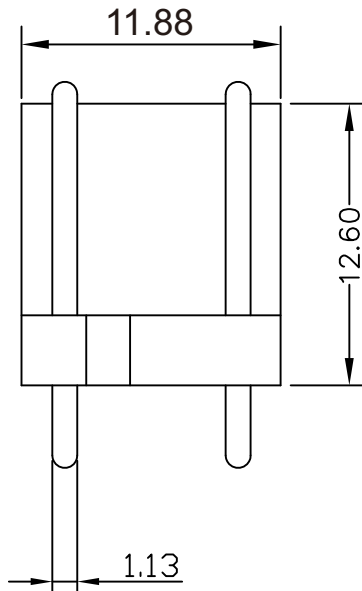

**RoHS Compliant**

TOLERANCES ARE

**MORETHANALL**  
PCB CONNECTORS  
Cable ASSEMBLIES

煜倫股份有限公司

www.morethanall.com

DRAWING BY CY

CHECKED BY GENIUS

UNIT/ mm SCALE 1:1

DATE

SIZE A4

X. ±  
.X ±  
.XX ±  
.XXX ±  
ANG ±

P PROJECTION



**ORDER INFORMATION**

KK-DRP-0302-LF  
SERIES | LEADFREE  
3P2C  
ROUND PIN  
DIP 180°

DESCRIPTION: 3.96mm Wire-to-Board Header Dip 180° Type