

NOTE:

1. 表面處理  
鍍錫 40u"以上

1. SURFACE TREATMENT:  
TIN PLATING  
THICKNESS MORE THAN 40u"

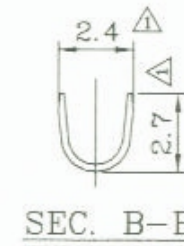
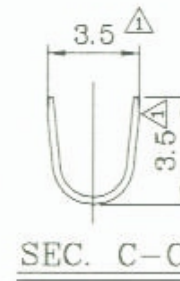
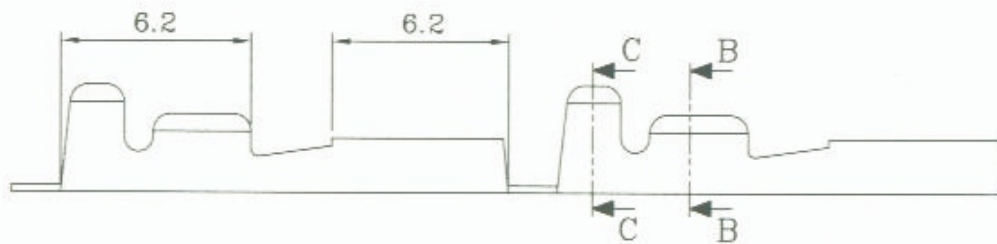
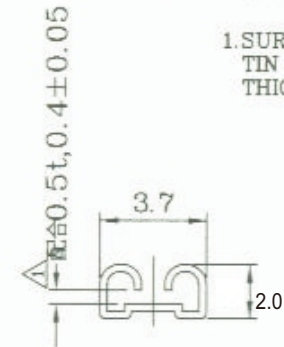
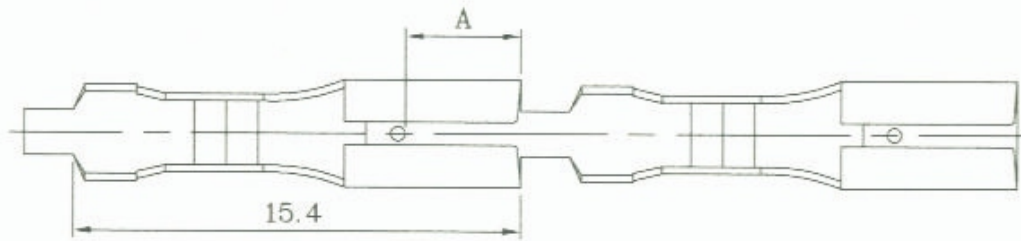

|                  |                |               |           |           |
|------------------|----------------|---------------|-----------|-----------|
|                  |                |               | 材質        | JIS2600EH |
| 1.0~1.5kg        | 1.5~2.5kg      | 1.5~6.0kg     | MATERIAL  |           |
| 0.7~1.0kg        | 1.0~1.8kg      | 1.5~6.0kg     | 料厚        | 0.25      |
|                  |                |               | THICKNESS |           |
| A 點插入力           | 插入力            | 拉拔力           | 間距        | 17.5      |
| A INSERTED FORCE | INSERTED FORCE | TENSILE FORCE | PITCH     |           |

適用電線 22~20  
WIRE RANGE  
包裝數量 15000  
PACKING QTY PCS/B

RoHS Compliant

TOLERANCES ARE

**MORETHANALL**  
PCB CONNECTORS  
Cable ASSEMBLIES

煜倫股份有限公司

www.morethanall.com

DRAWING BY CY

CHECKED BY GENIUS

UNIT / mm SCALE 1:1

DATE

SIZE A4

X, ±

.X, ±

.XX, ±

.XXX, ±

ANG, ±

P PROJECTION

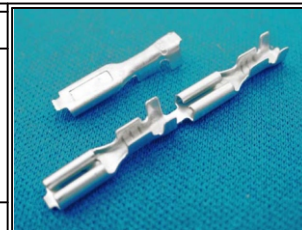

ORDER INFORMATION

Q110-FTx-20-LF

SERIES  
LEADFREE  
20~22AWG  
5:0.5mm TAB  
8:0.8mm TAB  
TERMINAL  
FEMALE

DESCRIPTION: