

Technical Data

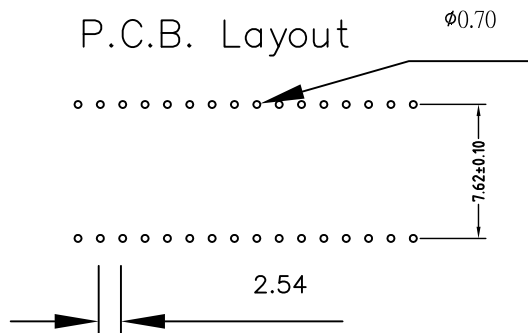
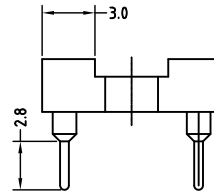
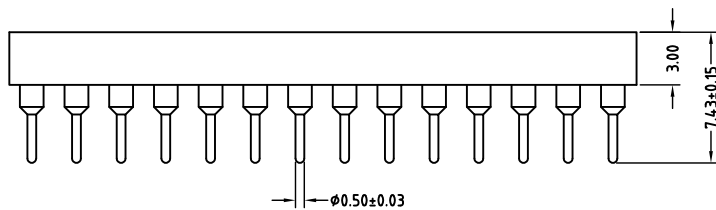
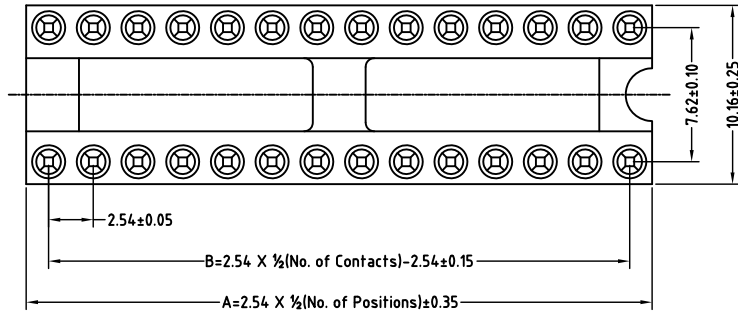

No. of Positions	DIM"A"	DIM"B"
6	7.62	5.08
8	10.16	7.62
14	17.78	15.24
16	20.32	17.78
18	22.86	20.32
20	25.40	22.86
24	30.48	27.94
28	35.56	33.02

Material:

Pin(outer sleeve): Brass,machined CuZn38Pb2
 Clip(contact 4 finger): Phosphor Bronze heat treated
 Plating(outer sleeve):
 Tin plated:2um/80u" Ni, 5um/200u" Sn
 Gold Plated:2um/80u" Ni,Full gold
 Plating(contact): 2um/80u" Ni, gold or Tin plated
 Insulator(black): Glass filled thermoplastic polyester
 UL94 V-0

Electrical:

Current rating: 3Amps/contact max.
 Contact resistance: $\leq 4m\Omega$ /contact
 Insulation resistance: $\geq 1000M\Omega$ at V=100V
 Operating voltage: 60VAC/DC

Mechanical:

Average insertion force with steel pin of $\phi 0.43mm/0.17"$: <250g
 Average withdrawal force with steel pin of $\phi 0.43mm/0.17"$: >50g min.
 Mechanical life cycle:min.200
 Operating temperatures: Gold Plsted:-55°C to+105°C
 Tin plated:-40°C to+105°C
 Soldering temperature: +260°C,10s max.

RoHS Compliant

TOLERANCES ARE

MORETHANALL
 PCB CONNECTORS
 Cable ASSEMBLIES

煜倫股份有限公司

www.morethanall.com

DRAWING BY CY

CHECKED BY GENIUS

UNIT/ mm

SCALE 1:1

DATE

SIZE A4

PPOJECTION

X, \pm
 .X ± 0.30
 .XX ± 0.20
 .XXX ± 0.10
 ANG \pm

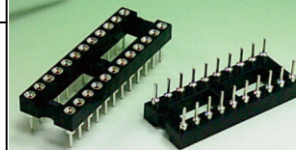

ORDER INFORMATION

SIC-D03-xx-LF
 SERIES | T | LEADFREE
 | | 06~48WAY
 | | SPACING 7.62mm
 DIP

DESCRIPTION: 2.54mmPitch IC Sockets Straight DIP Spacing 7.62mm Pin Length 7.43mm