

**SPECIFICATIONS**

Current Rating: 1A AC,DC  
 Voltage Rating: 100V AC,DC  
 Temperature Range: -25°C ~ +85°C  
 Contact Resistance: 20mΩ Max.  
 Insulation Resistance: 500MΩ Min.  
 Withstanding Voltage: 500V AC/minute  
 Pin Material: Brass/Tin-plated  
 Material: Nylon 66,UL94V-0

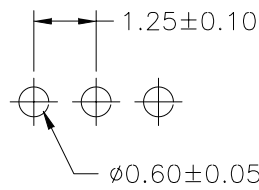

P.C.B. LAYOUT

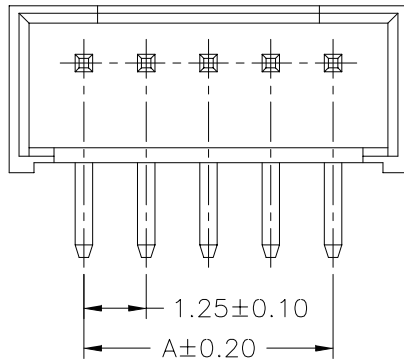
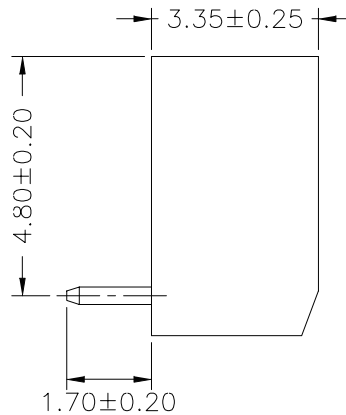
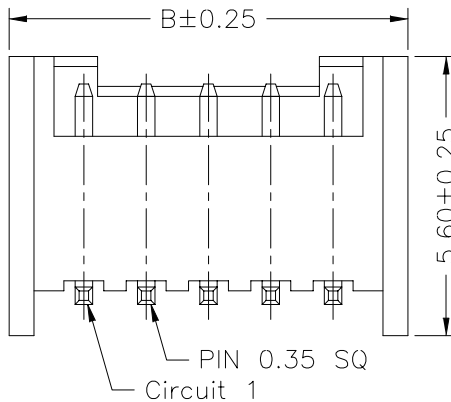

**Ordering Information & Dimensions**

PART NO.	Dimensions	
	A	B
ILZ-R-02	1.25	4.25
ILZ-R-03	2.50	5.50
ILZ-R-04	3.75	6.75
ILZ-R-05	5.00	8.00
ILZ-R-06	6.25	9.25
ILZ-R-07	7.50	10.50
ILZ-R-08	8.75	11.75
ILZ-R-09	10.00	13.00
ILZ-R-10	11.25	14.25
ILZ-R-11	12.50	15.50
ILZ-R-12	13.75	16.75
ILZ-R-13	15.00	18.00
ILZ-R-14	16.25	19.25
ILZ-R-15	17.50	20.50

**RoHS Compliant**

TOLERANCES ARE



煜倫股份有限公司

www.morethanall.com

DRAWING BY CY

CHECKED BY GENIUS

UNIT / mm

SCALE 1:1

DATE

SIZE A4

PPOJECTION

X, ±  
 .X ±  
 .XX ±  
 .XXX ±  
 ANG ±

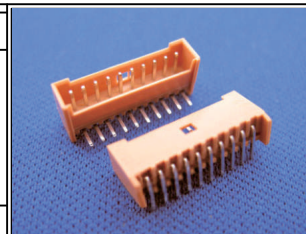

**ORDER INFORMATION**

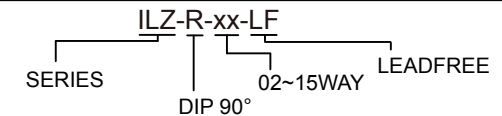

DESCRIPTION: 1.25mm PITCH 90° WAFER