

SECTION A-A

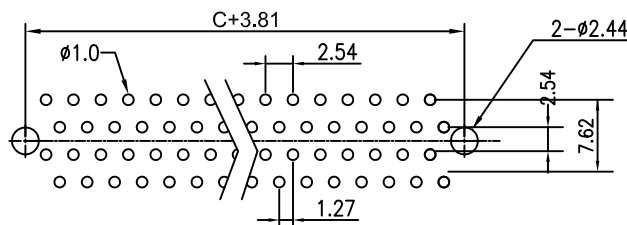
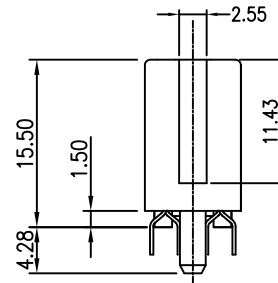
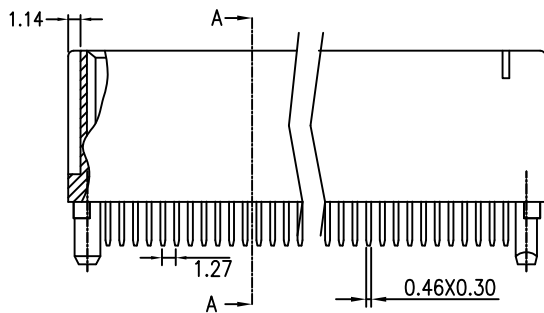

RECOMMENDED PCB LAYOUT (TOP VIEW)

MATERIAL

INSULATOR: PPS GLASS-REINFORCED THERMOPLASTIC UL94-V-0.
 CONTACT: BRASS.
 PLATING: MATING AREA - GOLD FLASH GOLD OVER NICKEL.
 SOLDER AREA - MAT TIN OVER NICKEL.

ELECTRICAL

VOLTAGE RATING: 250 VAC RMS.
 CURRENT RATING: 1 AMP.
 DIELECTRIC WITHSTANDING VOLTAGE: 500 VAC RMS 60Hz
 FOR 1 MINUTE.
 INSULATION RESISTANCE: 1000 MEGOHMS MIN AT 500 VDC.
 CONTACT RESISTANCE: 30 MILLIOHMS MAX.

MECHANICAL

RETENTION FORCE: 460 GRAMS MIN PER CONTACT.
 INSERTION FORCE: 230 GRAMS MAX PER CONTACT PAIR.
 WITHDRAWAL FORCE: 15 GRAMS MIN PER CONTACT PAIR.

ENVIRONMENTAL

TEMPERATURE RANGE: -55°C TO +85°C.
 SOLDERABILITY: 260°C/10 sec

Circuit	Dimension			Circuit	Dimension		
	A	B	C		A	B	C
04	8.64	3.81	1.27	38	30.23	25.40	22.86
06	9.91	5.08	2.54	40	31.50	26.67	24.13
08	11.18	6.35	3.81	42	32.77	27.94	25.40
10	12.45	7.62	5.08	44	34.04	29.21	26.67
12	13.72	8.89	6.35	46	35.31	30.48	27.94
14	14.99	10.16	7.62	48	36.58	31.75	29.21
16	16.26	11.43	8.89	50	37.85	33.02	30.48
18	17.53	12.70	10.16	52	39.12	34.29	31.75
20	18.80	13.97	11.43	54	40.39	35.56	33.02
22	20.07	15.24	12.70	56	41.66	36.83	34.29
24	21.34	16.51	13.97	60	44.20	39.37	36.83
26	22.61	17.78	15.24	124	84.84	80.01	77.47
28	23.88	19.05	16.51	128	87.38	82.55	80.01
30	25.15	20.32	17.78	160	107.70	102.87	100.33
32	26.42	21.59	19.05				
34	27.69	22.86	20.32				
36	28.96	24.13	21.59				

RoHS Compliant

TOLERANCES ARE



煜倫股份有限公司

www.morethanall.com

DRAWING BY CY

CHECKED BY GENIUS

UNIT / mm

SCALE 1 : 1

DATE

SIZE A4

PJECTION

0-10 ±0.2
 30-100 ±0.4
 OVER 300 ±0.6

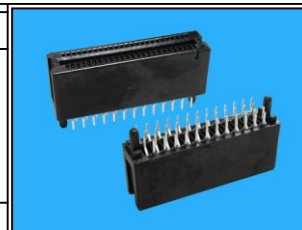

ORDER INFORMATION

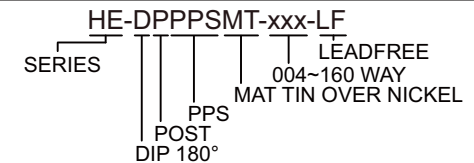

DESCRIPTION: 1.27 PITCH CARD EDGE DIP POS

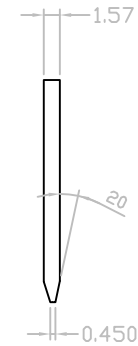
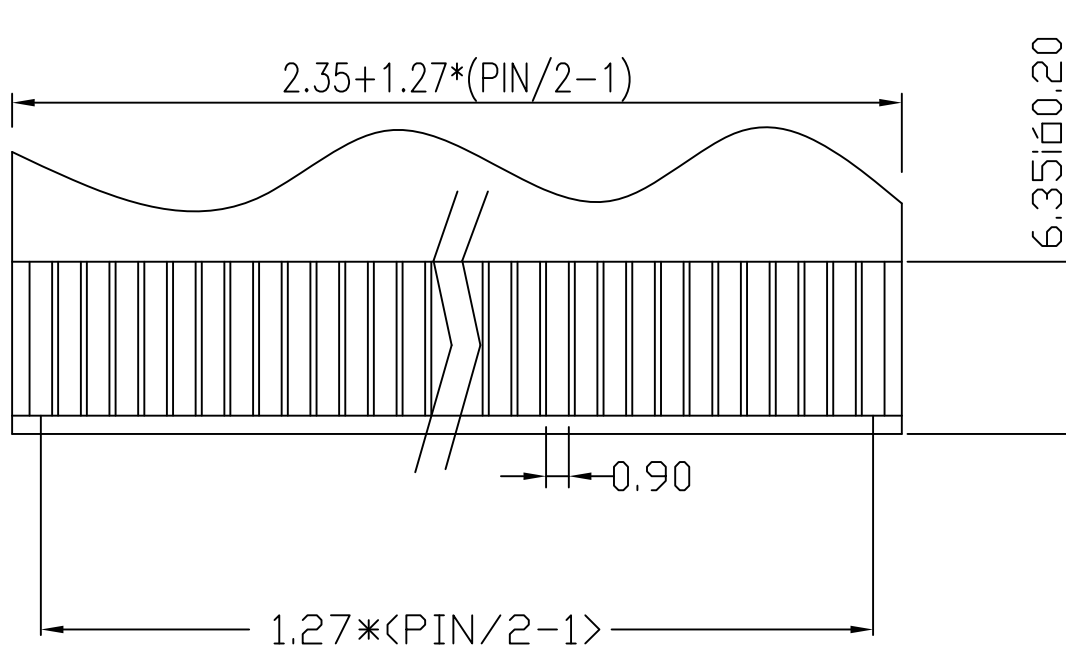

MORETHANALL
PCB CONNECTORS
Cable ASSEMBLIES

煜倫股份有限公司

www.morethanall.com

RoHS Compliant

DRAWING BY CY
CHECKED BY GENIUS
UNIT / mm SCALE 1 : 1
DATE

SIZE A4

TOLERANCES ARE

0-10 ± 0.2
30-100 ± 0.4
OVER 300 ± 0.6

PPOJECTION

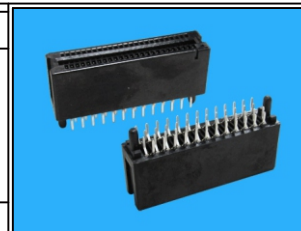

ORDER INFORMATION

HE-DPPPSMT-xxx-LF
SERIES | PPS | POST | DIP 180°
LEADFREE
004~160 WAY
MAT TIN OVER NICKEL

DESCRIPTION: 1.27 PITCH CARD EDGE DIP POS