

ELECTRICAL:

Impedance: 50 ohm

Frequency Range: DC-18 GHz

VSWR: N/A

Voltage Rating: 1500 V

Contact Resistance:

Center Contact < 2M Ohms

Outer Contact < 3M Ohms

Insulator Resistance: > 5000M Ohm

Environmental Temperature

Range: -65 to 165 (Celsius Degree)

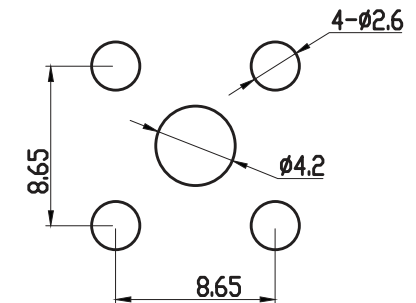

3	Insulator	PTFE	1	Natural
2	Contact PIN	Beryllium Copper	1	Gold
1	Body	Brass	1	Gold
ITEM	DESCRIPTION	MATERIAL	Q'TY	FINISHED

RoHS Compliant

TOLERANCES ARE

MORETHANALL
PCB CONNECTORS
Cable ASSEMBLIES

煜倫股份有限公司

www.morethanall.com

DRAWING BY CY

CHECKED BY GENIUS

UNIT / mm

SCALE 1 : 1

DATE

SIZE A4

P PROJECTION

0.5-15 = ±0.15
15-30 = ±0.30
30-120 = ±0.60
>120 = ±1.00
ANGLES
±5°

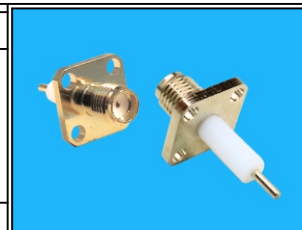

ORDER INFORMATION

SMA-JSPQP100050-50-LF
SERIES JACK PANEL SOLDER
SQUARE
LEADFREE
50 WAY
PIG 10.0+5.0mm

DESCRIPTION: SMA jack 4-hole panel receptacle