

Specifications:

Current rating:1.0A AC,DC
 Voltage rating:30V AC,DC
 Contact resistance:20m ohm Max
 Insulation resistance:1000M ohm Min
 Withstanding voltage:500V AC for one minute
 Operating Temperature:-40°C ~ +105°C

Materials:

Insulator:High Temp Plastic (Nylon46 UL94V-0)
 Insulator Color:Black
 Contact:Phosphor Bronze
 Contact Plated:Tin Plated

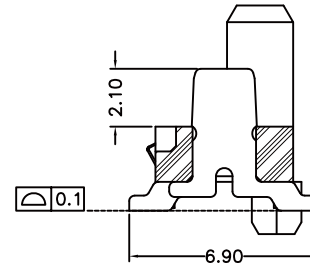
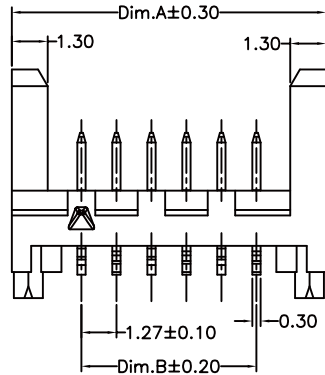
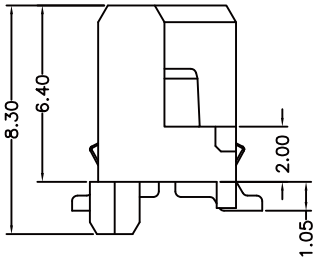

SECTION: A-A

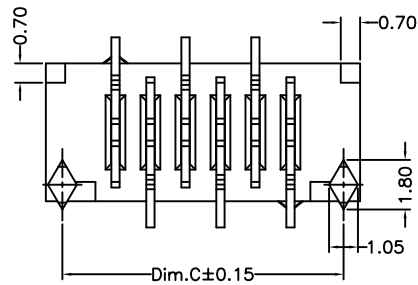

Dimension:

Pos.	Dimension:			Pos.	Dimension:		
	A	B	C		A	B	C
04	8.86	3.81	7.66	16	24.10	19.05	22.90
06	11.40	6.35	10.20	18	26.64	21.59	25.44
08	13.94	8.89	12.74	20	29.18	24.13	27.98
10	16.48	11.43	15.28	22	31.72	26.67	30.52
12	19.02	13.97	17.82	24	34.26	29.21	33.06
14	21.56	16.51	20.36	26	36.80	31.75	35.60

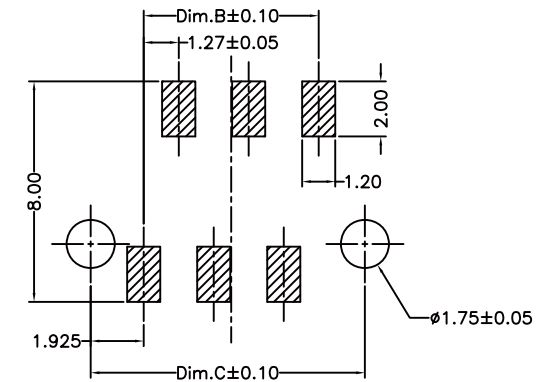

PCB LAYOUT

RoHS Compliant

TOLERANCES ARE



煜倫股份有限公司

www.morethanall.com

DRAWING BY CY

CHECKED BY GENIUS

UNIT / mm SCALE 1 : 1

DATE

SIZE A4

X, ±
 .X ±
 .XX ±
 .XXX ±
 ANG ±

P PROJECTION

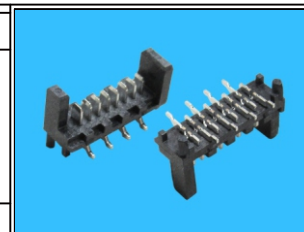

ORDER INFORMATION

PF-PVP64-xx-LF
 SERIES | | | LEADFREE
 | | | 04-26WAY
 | | | HIGH 6.4mm
 | | | POST
 | | | 180°SMT
 | | | MALE

DESCRIPTION: 1.27mm IDC Connector SMD Type