

RECOMMENDED P.C.B LAYOUT

CONTACTS	2X27
2X4	2X28
2X5	2X29
2X6	2X30
2X7	2X31
2X8	2X32
2X9	2X33
2X10	2X34
2X11	2X35
2X12	2X36
2X13	2X37
2X14	2X38
2X15	2X39
2X16	2X40
2X17	2X41
2X18	2X42
2X19	2X43
2X20	2X44
2X21	2X45
2X22	2X46
2X23	2X47
2X24	2X48
2X25	2X49
2X26	2X50

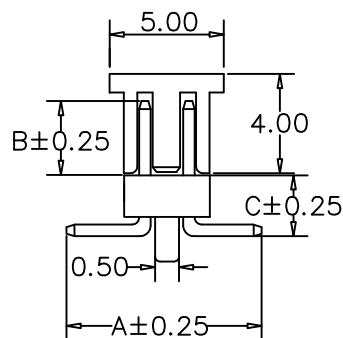
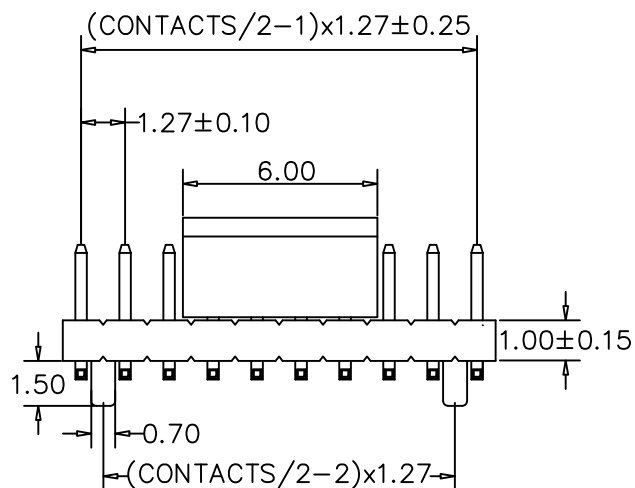

A: 5.50 mm B: 2.00 mm C: 1.60 mm

MATERIAL  
 HOUSING : NYLON 6T,UL94V-0  
 CONTACT : COPPER ALLOYS  
 PLATED : GODL FLASH  
 COLOR : BLACK

SPECIFICATION  
 CURRENT: 1A  
 OPERATING TEMPERATURE: -55°C TO +105°C  
 CONTACT RESISTANCE : 20 MILLIOHMS MAX  
 INSULATION RESISTANCE : 5000 MEGAOHMS MIN  
 DIELECTRIC STRENGTH : 1000 VAC MIN

RoHS Compliant

TOLERANCES ARE

**MORETHANALL**  
 PCB CONNECTORS  
 Cable ASSEMBLIES

DRAWING BY CY

CHECKED BY GENIUS

UNIT / mm

SCALE 1 : 1

DATE

SIZE A4

X. ±  
 .X ± 0.38  
 .XX ± 0.25  
 .XXX ±  
 ANG ± 5°

P PROJECTION

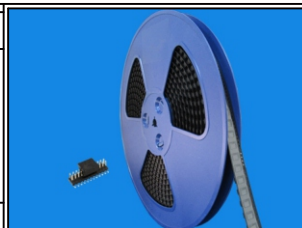

ORDER INFORMATION

PA-V16P20CR-2Xxx-LF  
 SERIES | | | | | LEADFREE  
 | | | | | 2X04:08 WAY  
 | | | | | 2X50:100 WAY  
 180°SMT REEL  
 HIGH 1.6mm POST CAP  
 CONTACT 2.0mm

DESCRIPTION:

煜倫股份有限公司

www.morethanall.com

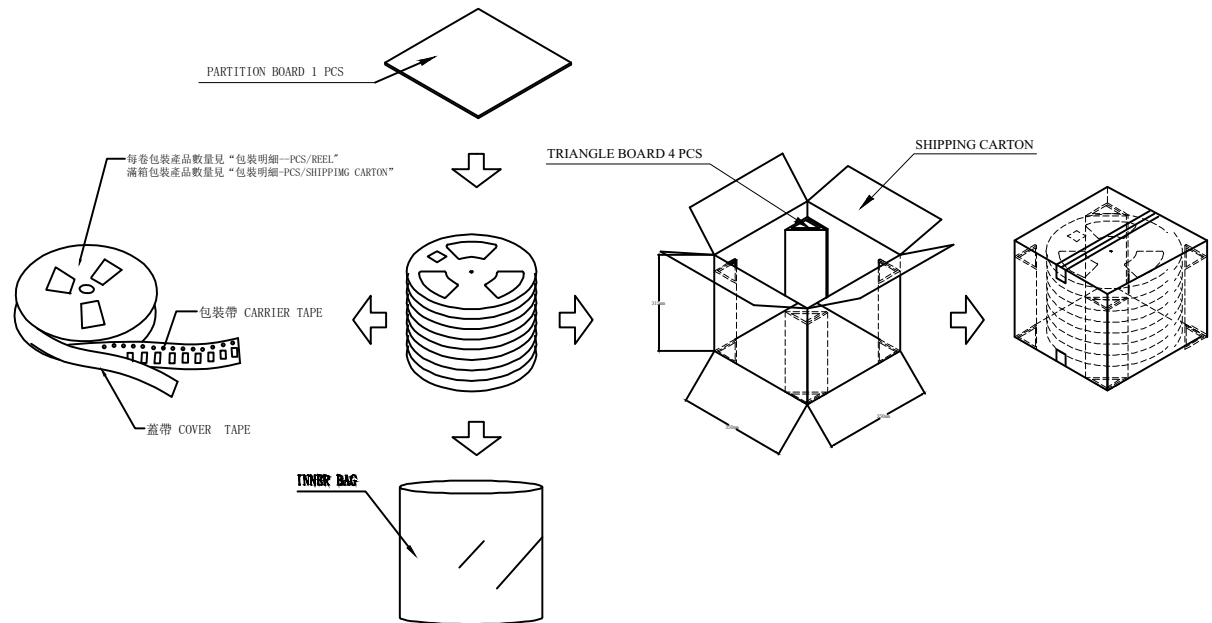

(1) 载带规格 (进料检验)

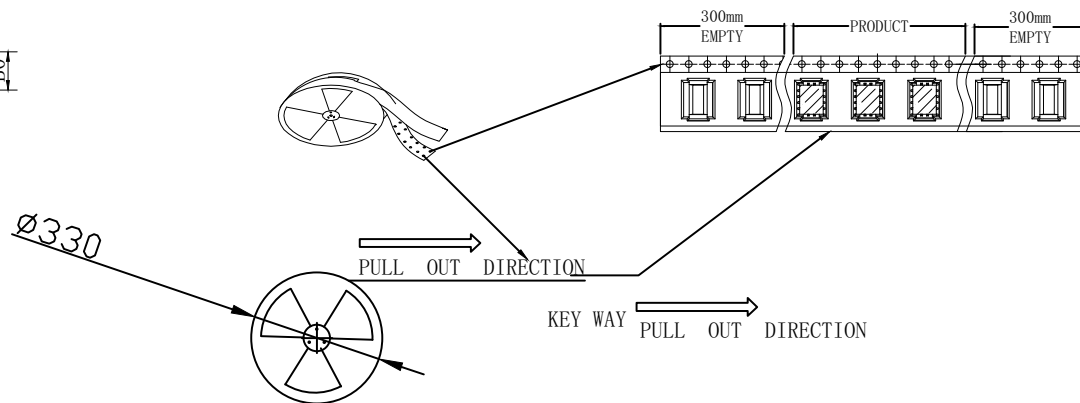
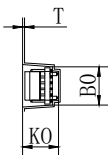
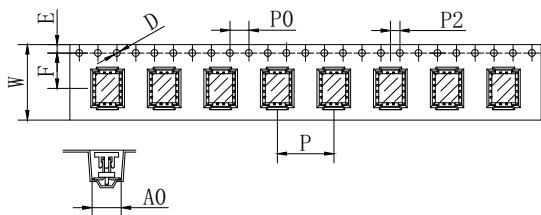

NO. OF CIRCUIT	DIM. W	DIM. P	PCS/ REEL	PCS/ SHIPPING CARTON	DIM. A0	DIM. B0	DIM. KO	DIM. E	DIM. F	DIM. P0	DIM. P2	DIM. D	DIM. T
2*6	16.00	12.00	650	7800	6.23	8.10	7.6	1.75	7.5	4.00	2.00	1.50	0.40
	$\pm 0.30$	$\pm 0.30$			$\pm 0.30$	$\pm 0.30$	$\pm 0.30$	$\pm 0.30$	$\pm 0.30$	$\pm 0.10$	$\pm 0.10$	$\pm 0.10$	$\pm 0.05$

包裝明細

RoHS Compliant

TOLERANCES ARE

**MORETHANALL**  
PCB CONNECTORS  
Cable ASSEMBLIES  
煜倫股份有限公司

DRAWING BY CY  
CHECKED BY GENIUS  
UNIT / mm SCALE 1 : 1  
DATE

X,  $\pm$   
.X  $\pm 0.38$   
.XX  $\pm 0.25$   
.XXX  $\pm 0.05$   
ANG  $\pm$

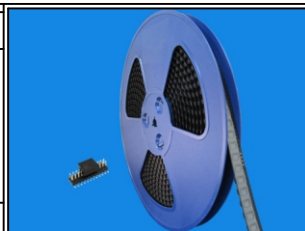

ORDER INFORMATION

PA-V16P20CR-2Xxx-LF  
SERIES | | | | | LEADFREE  
180°SMT | | | | | 2X04:08 WAY  
HIGH 1.6mm | | | | | 2X50:100 WAY  
POST | | | | | REEL  
CAP | | | | | CONTACT 2.0mm

www.morethanall.com

SIZE A4 PPROJECTION

DESCRIPTION: 1. 27PH PIN HEADER 0.4\*5. 3G SMT+CAP+POST H:1.00 2\*6PIN