

SEC:A-A

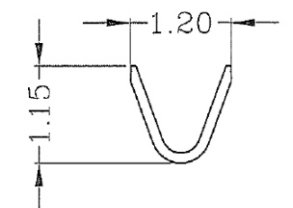

SEC:B-B

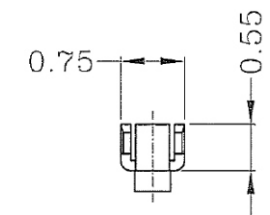

SEC:C-C

Specification & Ordering Information:

Part No.	Wire Range	Insulation O.D.	Material	Finish	Qty/reel
GH-T-28	AWG #28~#32	0.90mm(max)	Phosphor bronze	Tin-Plated	20,000 pcs

RoHS Compliant

TOLERANCES ARE

MORETHANALL
PCB CONNECTORS
Cable ASSEMBLIES

DRAWING BY CY

CHECKED BY GENIUS

UNIT / mm

SCALE 1:1

DATE

SIZE A4

PJECTION

X.±
.X±
.XX±
.XXX±
ANG±

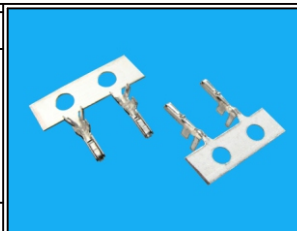

ORDER INFORMATION

GH-T-28-LF
SERIES | LEADFREE
28-32 AWG
TERMINAL

煜倫股份有限公司

www.morethanall.com

DESCRIPTION: