

**Specification**

- 1.Current Rating:0.5A AC/DC
- 2.Voltage Rating:30V AC/DC
- 3.Contact Resistance:20mΩ Max.
- 4.Insulation Resistance:100MΩ Min.
- 5.Withstand Voltage:AC200V/Minute
- 6.Operating Temperature:-25°C~+85°C

**Material:**

- 1.Housing:Thermoplastic UL94V-0
- 2.Contact Pin:Copper Alloy T=0.15
- 3.Tab:Copper Alloy T=0.20

**Finish:**

- 1.Housing:Natural
- 2.Contact Pin:Gold Plated
- 3.Tab:Gold Plated

**RECOMMENDED P.C.B LAYOUT**

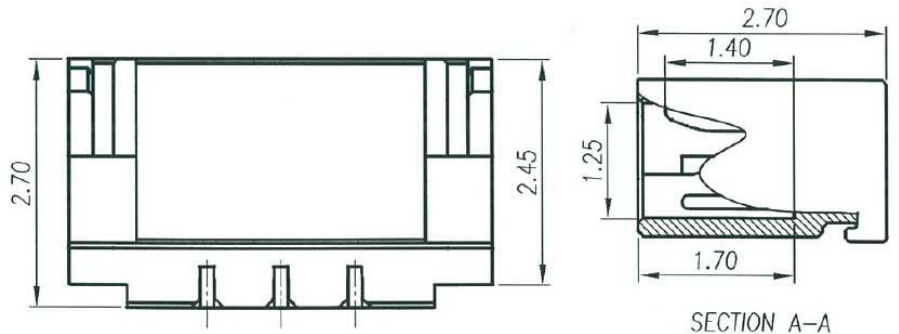
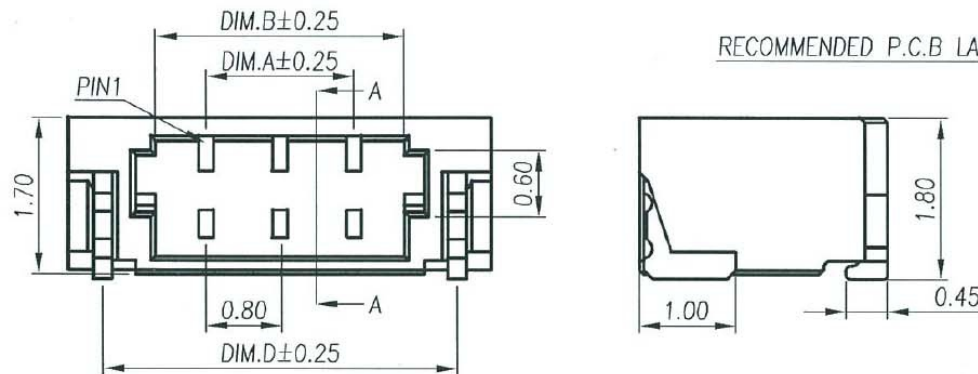

PIN	DIM.A	DIM.B	DIM.C	DIM.D	PIN	DIM.A	DIM.B	DIM.C	DIM.D
02	0.80	1.90	3.78	3.04	08	5.60	6.70	8.58	7.84
03	1.60	2.70	4.58	3.84	10	7.20	8.30	10.18	9.44
04	2.40	3.50	5.38	4.64	12	8.80	9.90	11.78	11.04
05	3.20	4.30	6.18	5.44	14	10.40	11.50	13.38	12.64
06	4.00	5.10	6.98	6.24	16	12.00	13.10	14.98	14.24
07	4.80	5.90	7.78	7.04	20	15.20	16.30	19.18	17.44

**RoHS Compliant**



煜倫股份有限公司

www.morethanall.com

DRAWING BY CY  
 CHECKED BY GENIUS  
 UNIT/mm SCALE 1:1  
 DATE  
 SIZE A4

**TOLERANCES ARE**

- X. ±
- .X ±
- .XX ±
- .XXX ±
- ANG ±

PPOJECTION

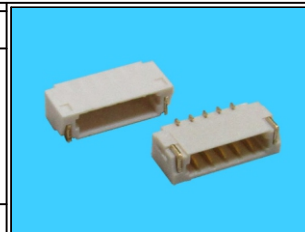

**ORDER INFORMATION**

SUR-W-xx-LF  
 SERIES | LEADFREE  
 | 02~20WAY  
 | 90° SMT

DESCRIPTION: SUR0.8mm Wire to Board Wafer SMT 90°