

Technical Data:

Material:

- Contact(metal housing): Brass Machined(Optional)
- Terminal screw: Steel Galvanized and chromated or Nickel plated or Tin plated(standard)(optian)
- Wire guard: PhBZ, Tin plated.
- Insulator body(housing): Polyamide(Glass filled)(UL94V-0)

Electrical

- Voltage rating: 300VAC
- Current rating: 10 Amps/way max
- Contact resistance: 20m (max)
- Insulation resistance: 5000M /1000V
- Withstanding Voltage: 1500VAC(1min) Test time=60sec/1pcs
- Wire range: 12-24AWG

Mechanical:

- Torque: 4kgf.cm/M3
- Operating temperature: -33°C to +120°C
- Soldering temperature= 250°C/5 seconds max

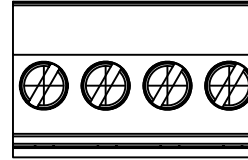

N=Number of contacts

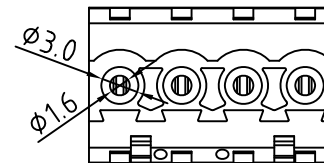
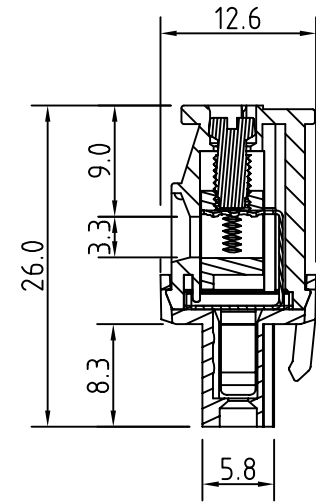
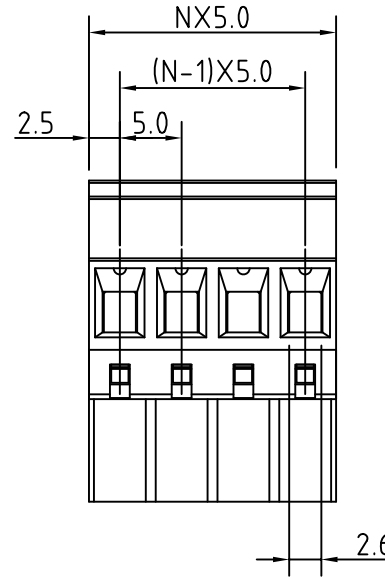

RoHS Compliant

TOLERANCES ARE

**MORETHANALL**  
PCB CONNECTORS  
Cable ASSEMBLIES

DRAWING BY CY

CHECKED BY GENIUS

UNIT / mm

SCALE 1 : 1

DATE

SIZE A4

PJECTION

X. ±  
.X ±  
.XX ±  
.XXX ±  
ANG ±

煜倫股份有限公司

www.morethanall.com

ORDER INFORMATION

TBH050-SVB-xx-LF

SERIES

LEADFREE

02-24WAY

BOTTOM SIDE

SCREW 180°

FEMALE

DESCRIPTION: