

MATERIAL

INSULATION: VINYL
MATERIAL: BRASS
TIN PLATING

NOTE:

1. MAXIMUM ELECTRICAL RATING: 105°C 300 VOLTS
2. WIRE RANGE: 22-16 AWG / 0.5-1.5 mm²
INSULATED COLOR: RED
3. WIRE RANGE: 16-14 AWG / 1.5-2.5 mm²
INSULATED COLOR: BLUE
4. WIRE RANGE: 12-10 AWG / 4-6 mm²
INSULATED COLOR: YELLOW
5. MATERIAL THICKNESS: t
TOLERANCE: ±0.05

MAXIMUM ELECTRIC CURRENT

A. W. G	22	20	18	16	14	12	10
MAX AMP	3	4	7	10	15	20	24

WIRE RANGE AWG/mm ²	產品編號 ITEM NO.	NEMA TAB	B	F ±0.30	L ±1.00	E	D ±0.30	d1 ±0.20	t
22-16 AWG 0.5-1.5 mm ²	Q250-FT8V-16	0.8x6.4	6.6±0.20	7.9	21.0	10.0	4.0	1.7	0.40

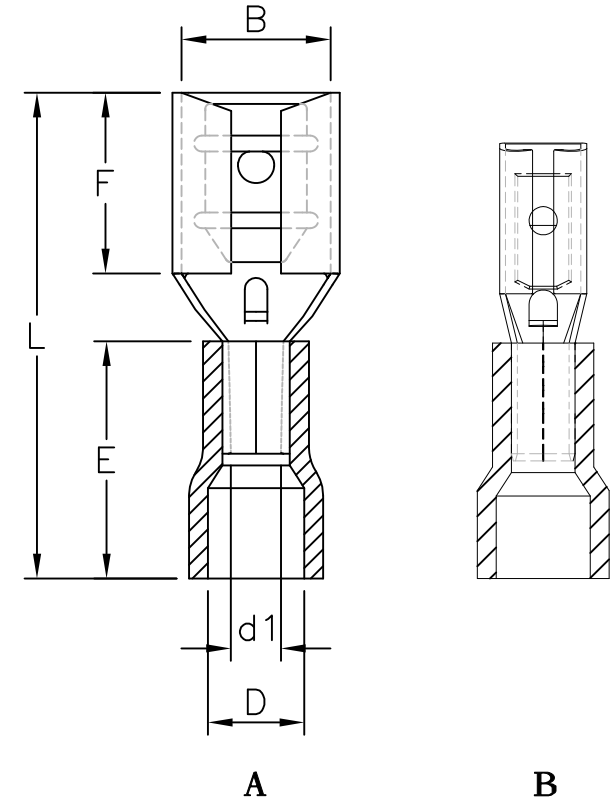

MORETHANALL
PCB CONNECTORS
Cable ASSEMBLIES
煜倫股份有限公司

www.morethanall.com

RoHS Compliant

DRAWING BY CY

CHECKED BY GENIUS

UNIT / mm

SCALE 1:1

DATE

SIZE A4

PJECTION

TOLERANCES ARE

X. ±
.X ±
.XX ±
.XXX ±
ANG ±



ORDER INFORMATION

Q250-FT8V-16-LF

SERIES LEADFREE
16-22 AWG
VINYL
THICKNESS 0.8mm
TIN PLATED
FEMALE

DESCRIPTION: