

NOTE:

CAVITY CONFORMS TO FCC RULES AND REGULATIONS PART 68, SUBPART F.

1. MATERIAL:
 - 1.1 HOUSING: PBT, WITH GLASS FIBER, UL94V-0, STANDARD COLOR-BLACK.
 - 1.2 INSERT HOUSING: PBT, WITH GLASS FIBER, UL94V-0, STANDARD COLOR-BLACK.
 - 1.3 CONTACTS: PHOSPHOR BRONZE.
2. FINISH:
 - 2.1 CONTACTS: GOLD PLATED ON ENTIRE CONTACT, 1.27µm [50µ"] MIN. NICKEL UNDERPLATED OVERALL.
3. "▽" SHOWS QIP INSPECTION POINT.

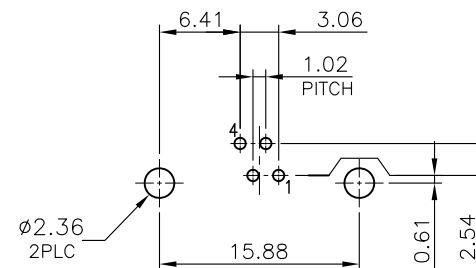

RECOMMENDED PCB LAYOUT
PCB THICKNESS: 1.6mm
TOLERANCE: ±0.05mm (TOP VIEW)

RoHS Compliant

TOLERANCES ARE

MORETHANALL
PCB CONNECTORS
Cable ASSEMBLIES

煜倫股份有限公司

www.morethanall.com

DRAWING BY CY

CHECKED BY GENIUS

UNIT / mm

SCALE 1 : 1

DATE

SIZE A4

PJECTION

X, ±
.X ± 0.25
.XX ± 0.13
.XXX ± 0.05
ANG ±

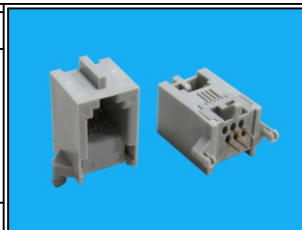

ORDER INFORMATION

MJ21-GX06-0404-LF

SERIES 4P4C LEADFREE
06u" GOLD
NON EAR
GRAY

DESCRIPTION: 4POSITION, PCB SCOKET