

NOTES:

ELECTRICAL:

- 1. VOLTAGE RATING : 125 VAC RMS.
- 2. CURRENT RATING : 1.5 AMP.
- 3. CONTACT RESISTANCE : 30 MILLIOHMSMAX
- 4. INSULATION RESISTANCE : 500 MEGOHMS MIN @ 500 NDC.
- 5. DIELECTRIC STRENGTH : 1000 VAC RMS 50Hz or 60Hz, 1MIN.

MECHANICAL:

- 1. HOUSING & INSERT MATERIAL : PBT UL94V-0.
- 2. CONTACT MATERIAL : DIAMETER 0.45MM PHOSPHOR BRONZE GOLD PLATING OVER NICKEL.
- 3. SHIELD : 0.20~0.25MM THICKNESS BRASS WITH TIN PLATED.
- 4. MATING/UNMATING FORCE : 2.2KG.F MAX.
- 5. RETENTION STRENGTH : 7.7KG.F MIN BETWEEN JACK AND PLUG.
- 6. OPERATING LIFE : 750 CYCLES MIN.

ENVIRONMENTAL:

- 1. STORAGE : -40°C ~ +85°C REATIVE HUMIDITY < 70%
 - 2. OPERATION : -40°C ~ +85°C
 - 3. IR Reflow Soldering Tempature: 255 To 265 (5-10 Seconds)
- Mates With Modular Plug conforming To FCC Part 68, Subpart F.

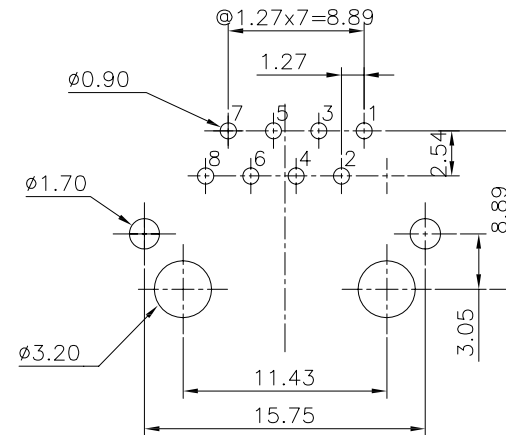

PC Board Layout t=1.6mm
Component Side Show

RoHS Compliant

TOLERANCES ARE



煜倫股份有限公司

www.morethanall.com

DRAWING BY CY

CHECKED BY GENIUS

UNIT / mm

SCALE 1 : 1

DATE

SIZE A4

X. ± 0.50

.X ± 0.38

.XX ± 0.25

.XXX ± 0.10

ANG ± 3°

P PROJECTION

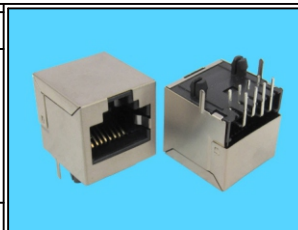

ORDER INFORMATION

MJF16C6U-KX06B3-0808-LF

SERIES

LEADFREE
8P8C
REAR TAB 3.05mm
06u" GOLD
NON EARS
BLACK

DESCRIPTION: RJ45 8P8C SIDE ENTRY PCB JACK Cat.6 TH