

Specifications

Current Rating: 2Amp

Insulation Resistance: 1000MΩ Min.

Dielectric Withstanding: 500V AC/DC

Contact Resistance: 20mΩ Max.

Operating Temperature: -40°C to +105°C

Materials

Contact Material: Phosphor Bronze

Insulation Material: Polyester, UL 94V-0
NYLON-6T

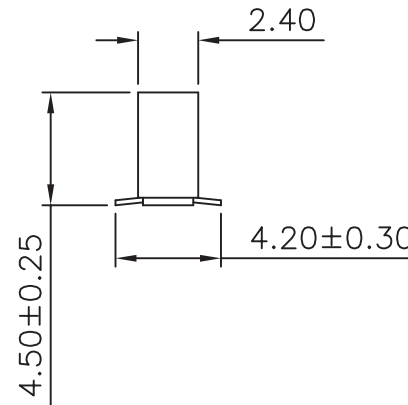
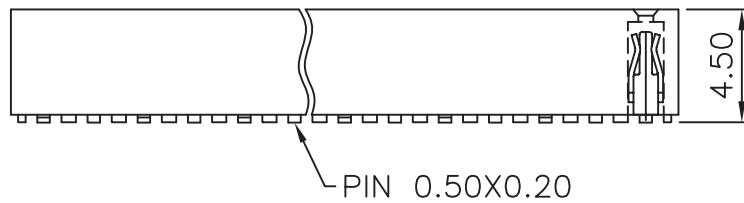
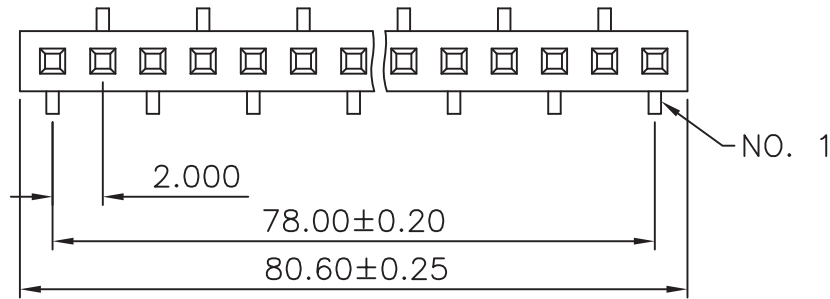

RECOMMENDED P.C.B LAYOUT

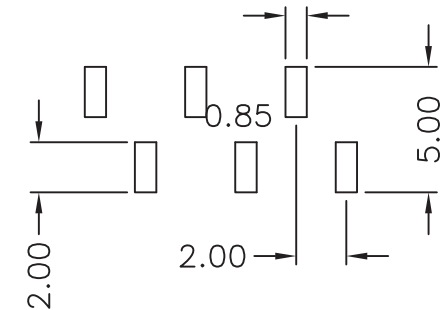

RoHS Compliant

TOLERANCES ARE

MORETHANALL
PCB CONNECTORS
Cable ASSEMBLIES

DRAWING BY CY

CHECKED BY GENIUS

UNIT/mm SCALE 1:1

DATE

SIZE A4

X. ±
.X ±
.XX ±
.XXX ±
ANG ±

PROJECTION

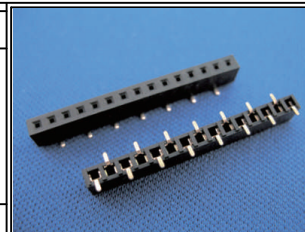

ORDER INFORMATION

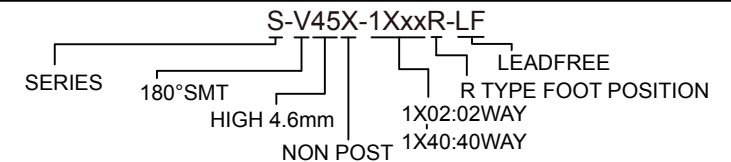

DESCRIPTION: 2.00 FEMALE HEADER SINGLE ROW SMT TYPE BASE 4.30H

煜倫股份有限公司

www.morethanall.com