

Recommended P.C. Board SMD Layout

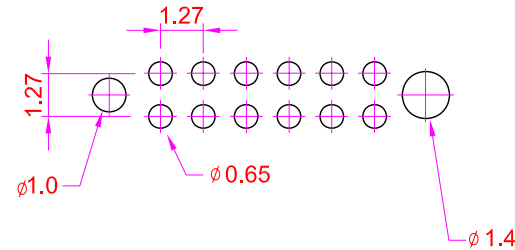

Specifications

Current Rating : 1 Amp
 Insulator Resistance : 1000 Megohms min.
 Contact Resistance : 20 m ohms max.
 Dielectric Withstanding : AC 300V
 Operating Temperature : $-40^{\circ}\text{C} \sim +105^{\circ}\text{C}$
 Contact Material : Phosphor Bronze
 Insulator Material : Polyester, UL 94V-0 LCP
 Contact Plated : See Option
 Standard: Full Gold Flash

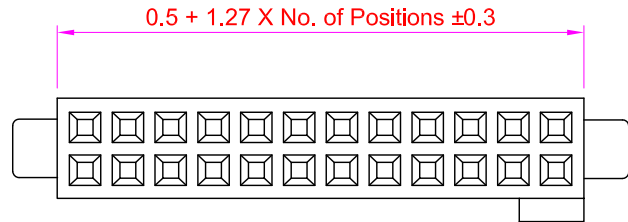
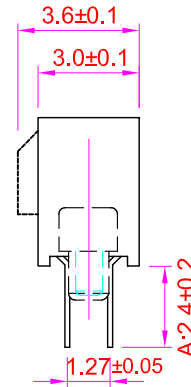
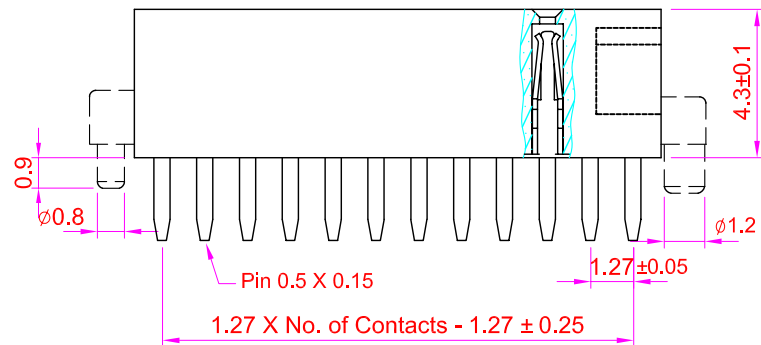

RoHS Compliant

TOLERANCES ARE

MORETHANALL
PCB CONNECTORS
Cable ASSEMBLIES

DRAWING BY CY

X, \pm

CHECKED BY GENIUS

.X \pm

UNIT / mm

SCALE 1 : 1

.XX \pm

DATE

.XXX \pm

ANG \pm

照片框

ORDER INFORMATION

YAB-D43P-2Xxx-LF
 SERIES | | LEADFREE
 | | 2X05:10WAY
 | | 2X50:100WAY
 POST
 HIGH 4.3mm
 DIP 180°

煜倫股份有限公司

www.morethanall.com

SIZE A4

PJECTION

DESCRIPTION: Female Header P1.27X1.27mm Profile : 4.3mm, Dual Row, Straight Type