

MATERIAL: BRASS(青銅) SH  
 THICKNESS: 0.25mm  
 PLATING: TIN 40u"MIN

WIRE RANGE: SUITABLE FOR AWG#16~20

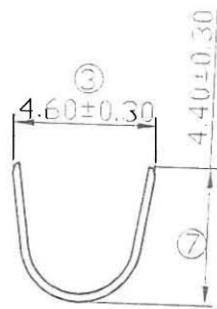

Section A-A

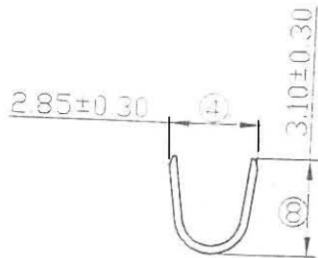

Section B-B

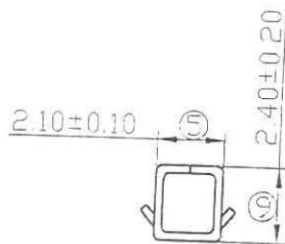

Section C-C

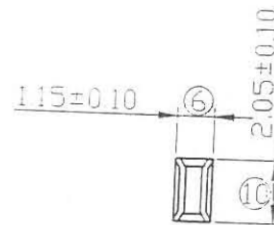

Section D-D

RoHS Compliant

TOLERANCES ARE

**MORETHANALL**  
 PCB CONNECTORS  
 Cable ASSEMBLIES

煜倫股份有限公司

www.morethanall.com

DRAWING BY CY

CHECKED BY GENIUS

UNIT / mm SCALE 1 : 1

DATE

SIZE A4

X. ±  
 .X ±  
 .XX ±  
 .XXX ±  
 ANG ±

P PROJECTION

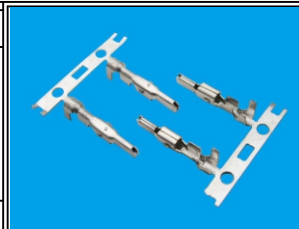

ORDER INFORMATION

VU-M-16-LF  
 SERIES | LEADFREE  
 16~20 AWG  
 MALE TERMINAL

DESCRIPTION: