

NOTES

1. LEAD TAPE LENGTH
PULL OUT DIRECTION

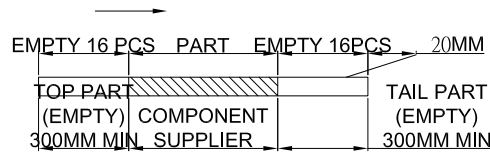

2. PEELING OFF FORCE OF TOP TAPE: 0.1~1.3N (10.2gf~130gf)
THIS REQUIREMENT SHOULD BE APPLIED AT SHIPMENT:
PEELING OFF SHOULD NOT BE ALLOWED DURING TRANSPORTATION

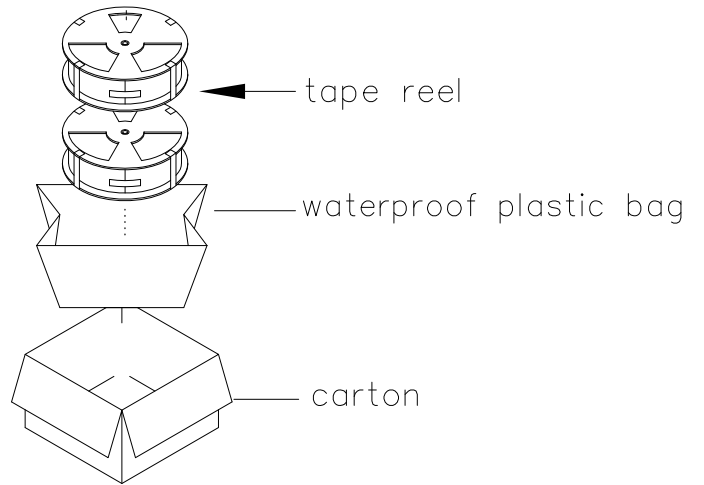
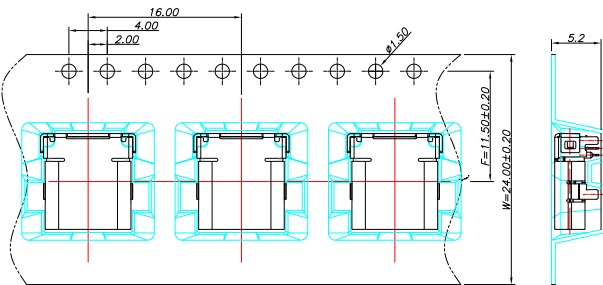
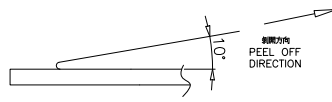

at small positioning hole of the carrier tape side.
Location of label sticking (label)

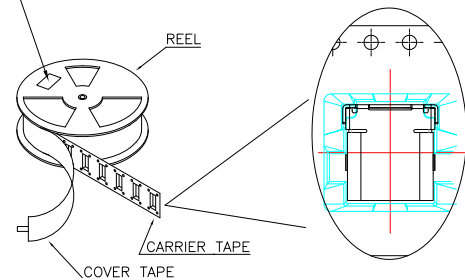

NOTE:

1. Packing q'ty of each reel & carton as below table shown.
2. Use cover tape to cover and hot melt machine to seal up.
3. Every carton use 2pcs EPE.
4. Put reels in the carton and use adhesive tape to seal up.

(PACKING CAPACITY)		
PCS/REEL	REELS/CARTON	PCS/CARTON
800	10	8000

RoHS Compliant

TOLERANCES ARE

MORETHANALL
PCB CONNECTORS
Cable ASSEMBLIES

DRAWING BY CY

CHECKED BY GENIUS

UNIT / mm

SCALE 1 : 1

DATE

SIZE A4

P PROJECTION

Up to 5 ±0.2
Above 5 ~ 15 ±0.3
Above 15 ~ 30 ±0.4
Above 30 ~ 50 ±0.5
Angle ±0.3°

照片框

ORDER INFORMATION

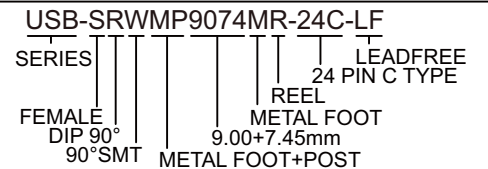

DESCRIPTION: USB 3.1 TYPE C SMT脚+PIN脚长1.25 定位柱距离7.45mm

煜倫股份有限公司

www.morethanall.com