

NOTE:

1.ELECTRICAL CHARACTERISTICS;

1.1 CONTACT RESISTANCE: 40mΩ Max FOR INITIAL. 50mΩ CHANGE AFTER TEST. MEASURE AT 20mV, 100mA.

1.2 CONTACT CURRENT RATING: 3A FOR VBUS PIN; 1.25A FOR VCONN PIN.

1.3 DIELECTRIC WITHSTANDING VOLTAGE: 100V AC R.M.S.

1.4 INSULATION RESISTANCE 100MΩ Min

1.5 OPERATING TEMPERATURE: -25°C ° 80°C

2.MECHANICAL CHARACTERISTICS:

2.1 MATING FORCE: 5~20N

2.2 UNMATED FORCE: 8~20N

2.3 DURABILITY: 10,000 CYCLES

| | | | | | |
|-----|------------|------|---------------|---------------------|---|
| 6 | RESISTANCE | 1 | / | 0402 | 56K Ω |
| 5 | Shell | 1 | SUS | T=0.15mm | matte Tin Plated/Nickel Plated |
| 4 | LATCH | 1 | SUS | T=0.30mm | matte Tin Plated/Nickel Plated |
| 3 | Gnd plates | 2 | SUS | T=0.10mm | Solder area: Gold Plated |
| 2 | Contact | 24 | COPPER ALLOY | T=0.15mm | Contact area: 1u" PD/Ni+Gold Plated Solder area: 80u"min. matte Tin Plated over Nickel |
| 1 | Housing | 3 | THERMOPLASTIC | UL 94-V0 | Black |
| No. | Name | Q'ty | Material | Remarks & Thickness | Finish |

RoHS Compliant

TOLERANCES ARE

MORETHANALL
PCB CONNECTORS
Cable ASSEMBLIES

DRAWING BY CY

CHECKED BY GENIUS

UNIT / mm

SCALE 1 : 1

DATE

SIZE A4

X, ±
.X ± 0.30
.XX ± 0.20
.XXX ± 0.10
ANG ± 1°

PJECTION

照片框

ORDER INFORMATION

USB-PS-24C-LF
SERIES | LEADFREE
24 WAY C TYPE
SOLDER
MALE

煜倫股份有限公司

www.morethanall.com

DESCRIPTION: USB C TYPE(M) 2.0 拉伸殼 帶PCB

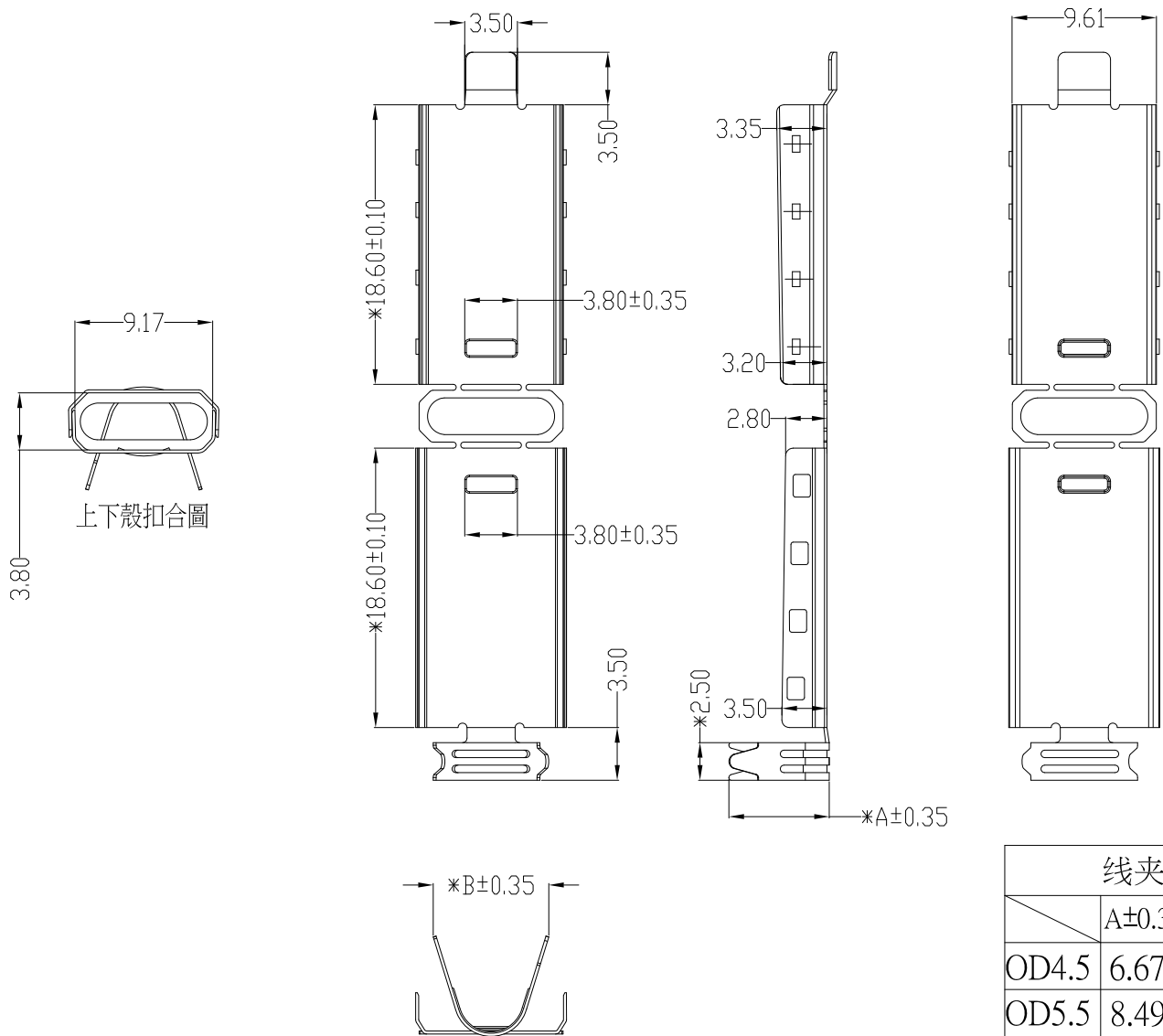

注：

- 1.*為必須檢測尺寸
- 2.外觀:不能有毛邊,压痕,变形,及表面脏污.
- 3.材質:SUS 1/2H T=0.20mm.
- 4.电镀：表面镀镍30u"MIN
- 4.符合RoHS環保標準
- 5.未注公差依公差表

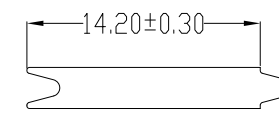

P/N: 001-A624-S80B
OD4.0-4.5

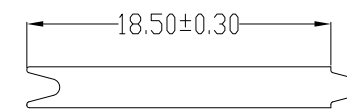

P/N: 001-A624-S80E
OD5.0-5.5

线夹尺寸表

| | A±0.35 | B±0.35 |
|-------|--------|--------|
| OD4.5 | 6.67 | 7.69 |
| OD5.5 | 8.49 | 8.80 |

RoHS Compliant

TOLERANCES ARE

MORETHANALL
PCB CONNECTORS
Cable ASSEMBLIES

DRAWING BY CY

CHECKED BY GENIUS

UNIT / mm

SCALE 1 : 1

DATE

SIZE A4

X, ±
.X ± 0.30
.XX ± 0.20
.XXX ± 0.10
ANG ± 1°

PJECTION

照片框

ORDER INFORMATION

USB-PS-24C-LF
SERIES | LEADFREE
24 WAY C TYPE
SOLDER
MALE

煜倫股份有限公司

www.morethanall.com

DESCRIPTION: USB C TYPE(M) 裝配殼