

Material:

Housing: 30% Glass filled PBT UL94V-0.
 Contacts: Phosphor Bronze.
 Coaxial or Power: Cu Alloy.

Electrical Characteristics:

Current Rating: 2 AMP.
 Dielectric Withstanding Voltage: AC 1000V For 1 minute.
 Insulator Resistance: 1000M Ω min. at DC 500V.
 Contact Resistance: 30m Ω max. at DC 100mA.
 Operating Temperature: -55°C ~ +105°C .

* **RoHS Compliant**

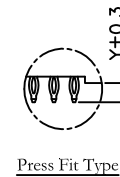
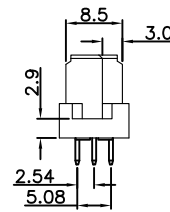
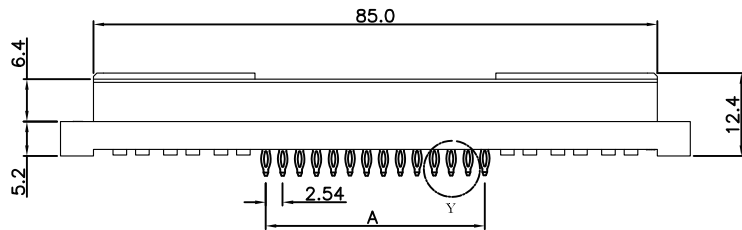

Press Fit Type

Length	1	2	W1	W2
Y	4.6	6.3	13	17
Dimension				
A	(2.54 x No of Contact)/3-2.54			
B	(7.62 x No of Coaxial)/2-7.62			
Pitch	Position	Rows with Contacts	Contact Arrange	With Coaxial Or Power
2.54mm	78	a b c		2 Pcs
	60	a b c		4 Pcs
	42	a b c		6 Pcs
	24	a b c		8 Pcs
	6	a b c		10 Pcs
	52	a - c		2 Pcs
	40	a - c		4 Pcs
	28	a - c		6 Pcs
	16	a - c		8 Pcs
	4	a - c		10 Pcs

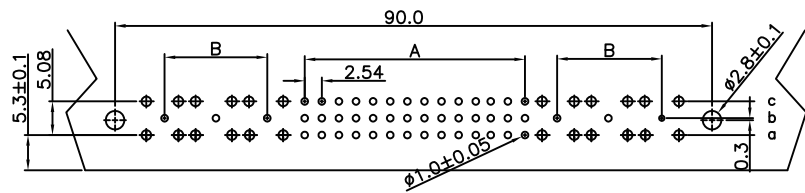

P.C. Board Layout (Coaxial)

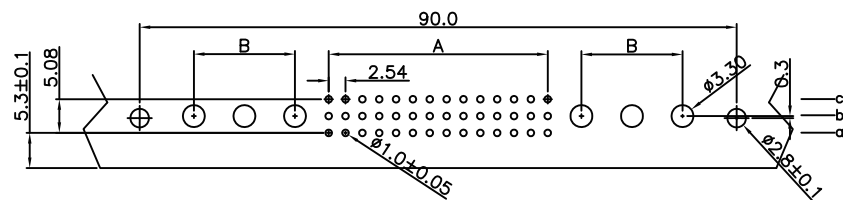

P.C. Board Layout (Power)

RoHS Compliant

TOLERANCES ARE



煜倫股份有限公司

www.morethanall.com

DRAWING BY CY
 CHECKED BY GENIUS
 UNIT / mm SCALE 1 : 1
 DATE
 SIZE A4 PPROJECTION

X, ±
 .X ±
 .XX ±
 .XXX ±
 ANG ±

照片框

ORDER INFORMATION

UM-SPxx-xx+x-LF
 SERIES | LEADFREE
 04+10
 78+2
 FEMALE 04:4.0mm
 PRESS FIT 06:6.3mm
 13:13.0mm
 17:17.0mm

DESCRIPTION: