

## FEATURE

1. THIS IS TYPE C PLUG TO STANDARD A RECEPTACLE ADAPTER ASS'Y.
2. THIS CABLE IS DESIGNED TO COMPLY WITH USB1.2 TYPE C SPECIFICATION.
- 3 ELECTRICAL FOR CABLE
- 3.1 CONDUCTOR RESISTANCE: 5Ω MAX AT 20°C FOR CABLE AREA.
- 3.2 INSULATION RESISTANCE: 300VDC 20MΩ MIN FOR 10ms
- 3.3 OPEN&SHORT TEST 100%
- 3.4 THIS CABLE IS NOT ELECTRONICALLY MARKED.
- 3.5 CAPACITOR C1:10nF±10%
- 3.6 RESISTOR Rd:5.1KΩ±20%
4. GREEN ENVIRONMENT PROTECTION:  
ALL PARTS ARE THE MICRO POLLUTANT
5. SYMBOL DESCRIPTION:

MAJOR DIMENSION x 6	(4) MATERIAL
CPK DIMENSION x 0	(Δ) REVISION
DIMENSION NUMBER	( ) REFERENCE

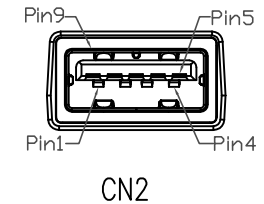
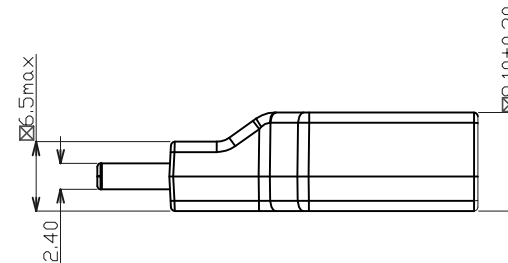
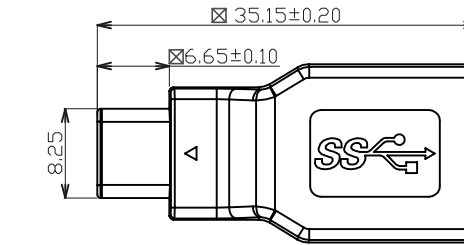
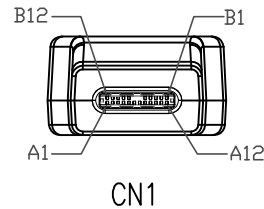

## PIN ASSIGNMENT

CN1 (Type C Plug )		CN2(USB3.0 Std-A Receptacle)	
Pin	Signal Name	Pin	Signal Name
A1,B1,A12,B12	GND	4	GND
A4,B4,A9,B9	Vbus	7	GND_DARIN
A5	CC	1	Vbus
B5	Vconn		
A6	Dp1	3	D+
A7	Dn1	2	D-
A2	SSTXp1	9	StdA_SSTX+
A3	SSTXn1	8	StdA_SSTX-
B11	SSRXp1	6	StdA_SSRX+
B10	SSRXn1	5	StdA_SSRX-
SHELL	Shield	SHELL	Shield

Notes:

1. Pin A5 (CC) of the USB Type-C plug shall be connected to GND through a resistor R (5.1KΩ ±20%). See Section 4.5.3.2.1 and Table 4-15 for the functional description and value of Rd.
2. This table is based on the assumption that shielded twisted pair is used for all SGP 7's and there are drain wires. If coaxial wire construction is used, then no drain wires are present and the shields of the coaxial wires are connected to the ground pins.
3. Contacts B6 and B7 should not be present in the USB Type-C plug.
4. All VBUS pins shall be connected together within the USB Type-C plug. A 10 nF bypass capacitor is required for the VBUS pin in the USB Type-C plug end of the cable. The bypass capacitor should be placed as close as possible to the power supply pad. A bypass capacitor is not required for the VBUS pin in the Standard-A receptacle.
5. All Ground return pins shall be connected together within the USB Type-C plug.
6. All USB Type-C plug pins that are not listed in this table shall be open (not connected).

8	TYPE C TO A-F SLEEVE	TYPE C TO A-F SLEEVE Plastic PC+ABS BLACK UL94V-0	/	1
7	YMA-PEL0100P07	YUSHUNRONG LD-PE HF	/	1
6	YWE-02-020M050	Conductive Copper Foil Tape W28*50/R*10.06mm	/	1
5	TAR2M COVER	TAR2M Plastic Cover PC+ABS BLACK UL94V-0	/	1
4	Rd & C	SMD Resistor 5.1KΩ±10% 0402 + Chip Capacitor 10nF±10% 30V 0402	/	1
3	TYPE C TO A-F PCB	TYPE C TO A Receptacle PCB FR-4 T0.8mm 4 Layout,Cu T=1 Oz,	/	1
2	TAR2M-9VG394	USB3.0 TYPE A RECEPTACLE SOLDER TYPE PLATED GOLD 30U*FOUR TYPE + UP/DOWN SHELL	/	1
1	NAW10-AK5150	USB TYPE C PLUG+Up Shell&Down Shell,	/	1
ITEM	ACON P/N OR NAME	MATERIAL/DESCRIPTION	DIM	QTY
BOM LIST				

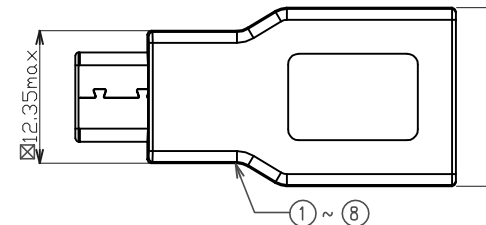

## RoHS Compliant

TOLERANCES ARE

**MORETHANALL**  
PCB CONNECTORS  
Cable ASSEMBLIES

煜倫股份有限公司

www.morethanall.com

DRAWING BY CY

CHECKED BY GENIUS

UNIT / mm SCALE 1 : 1

DATE

SIZE A4

X, ±  
.X ±  
.XX ±  
.XXX ±  
ANG ±

PPOJECTION

照片框

## ORDER INFORMATION

UBX2-EM-24C9A-LF

SERIES

LEADFREE

24 C TYPE TO 9 PIN A TYPE

MOLDING

MALE TO FEMALE

DESCRIPTION: Type C Plug to Std-A Receptacle Adapter 3A