

Model No.	POS.1	POS.2	POS.3
	2US1	ON	NONE
Term. Comm.	2-3	OPEN	2-1
SCHEMATIC			

SWITCH FUNCTION

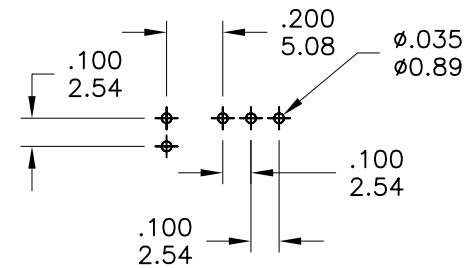

PC MOUNTING

**SPECIFICATIONS**

- MECHANICAL LIFE:** 40,000 make-and-break cycles.
- CONTACT RATING:** 0.4 VA max. @ 20 V AC or DC max.
- CONTACT RESISTANCE:** Below 100 mΩ typ. initial @ 2-4 V DC, 100 mA.
- INSULATION RESISTANCE:** 1,000 MΩ min.
- DIELECTRIC STRENGTH:** 500 Vrms min. @ sea level.
- OPERATING TEMPERATURE:** - 30°C±85°C

**MATERIALS**

- HOUSING AND BASE:** Glass filled nylon 6/6 or 4/6 , flame retardant, heat stabilized(UL94V-0)
- ACTUATOR:** Glass filled nylon 6/6 , flame retardant, heat stabilized(UL94V-0), with standard internal o-rjng seal
- SWITCH SUPPORT:** Piano wire.
- STATIONARY CONTACTS:** Copper alloy, with gold plate over nickel plate.
- TERMINALS:** C268, with gold plate over nickel plate.
- TERMINAL SEAL:** Epoxy. All terminals Insert molded.
- NOTE:** Specifications and materials listed above are for switches with standard options. For information on specific and custom switches, consult Customer Service Center.

**RoHS Compliant**

TOLERANCES ARE



煜倫股份有限公司

www.morethanall.com

DRAWING BY CY		X, ± .X ± .XX ± .XXX ± ANG ±
CHECKED BY GENIUS		
UNIT / mm	SCALE 1 : 1	
DATE		
SIZE A4	P PROJECTION	

照片框

**ORDER INFORMATION**

TGSW26-RM038-3X01-LF  
 SERIES | LEADFREE  
 3.8mm | 03 WAY  
 METAL  
 DIP 90°

DESCRIPTION: