

- △ Material
- Terminal body (Contact pin): Brass
  - Wire guard: Stainless steel
  - Surface of solder tail: Tin plated
  - Insulator (housing): Thermoplastic (UL94V-0)

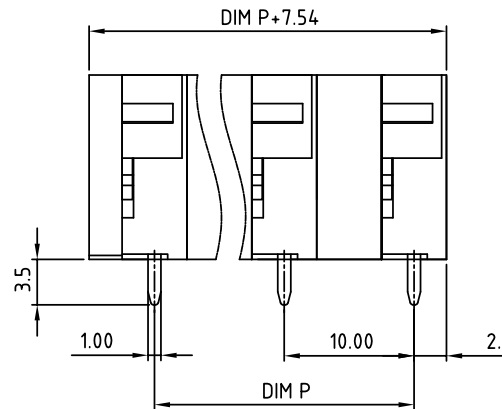

- △ Electrical cULus/VDE
- Voltage rating: 300VAC/450VAC
  - Current rating: 10A/10A
  - Wire range: 0.75-1.5mm<sup>2</sup>
  - Solid wire(AWG): 14-24
  - Stranded wire(AWG): 14-24
  - Pull force:
  - Screw:
  - Wire strip length: 9-10mm
  - Withstanding Voltage: 1.6KV/2.5KV
  - Operating temperature: -40°C to +115°C
  - △ Soldering temperature: 250°C±10°C/5 Sec
  - Safety Approval:

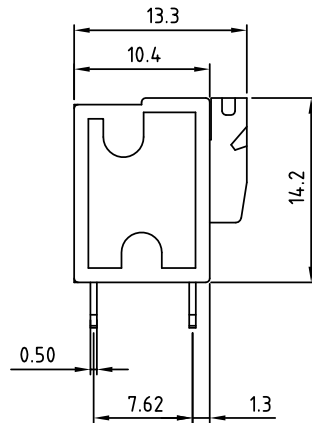

N=Number of contacts

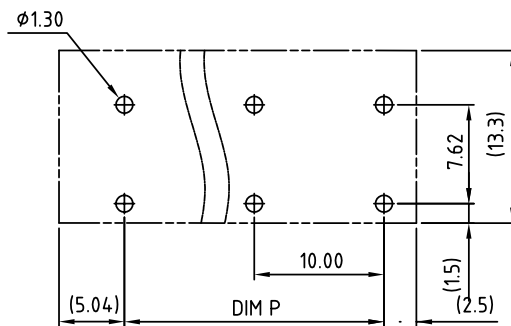

P.C.B. LAYOUT

N = Number of poles  
Dim P=(N-1)x10.0

	Dim P
2-6p	±0.10
7-12p	±0.20
13-18p	±0.25
19-24p	±0.30

RoHS Compliant

TOLERANCES ARE

**MORETHANALL**  
PCB CONNECTORS  
Cable ASSEMBLIES

煜倫股份有限公司

www.morethanall.com

DRAWING BY CY

CHECKED BY GENIUS

UNIT / mm SCALE 1 : 1

DATE

SIZE A4

X. ± 0.50

.X ± 0.30

.XX ± 0.10

.XXX ±

ANG ± 1°

P PROJECTION

照片框

ORDER INFORMATION

TBX100-D14B-xx-LF

SERIES | | | LEADFREE  
| | | 02-24 WAY  
| | | TWO LEG  
| | | HIGH 14.0mm  
| | | DIP 180°

DESCRIPTION: