

N=Number of contacts

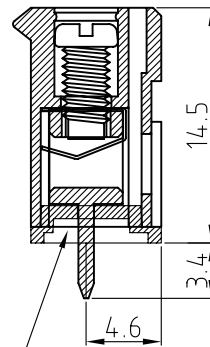

BOTTOM COVER FOR OPTION

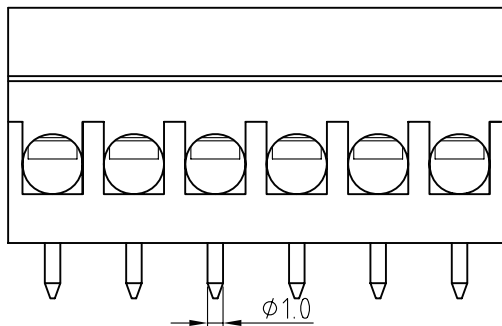
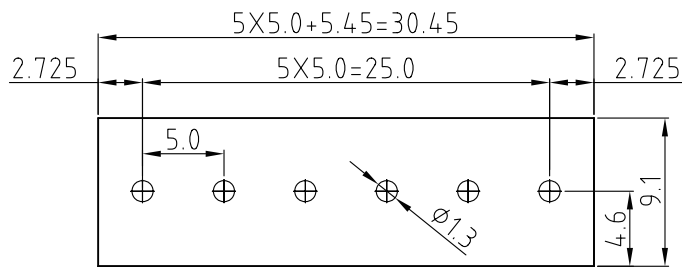

P.C.B. LAYOUT

Technical Data:

Material:

- Contact(metal housing): Brass (CuZn)
- Terminal screw: Steel galvanized with Cr3+ plated
- Wire guard: Stainless steel
- Insulator body(housing): Polyamide(Glass filled)(UL94V-0)

Electrical

- Voltage rating: 250VAC
- Current rating: 15 Amps/way max
- Contact resistance: 20mΩ(max)
- Withstanding Voltage: 2500VAC(1min) Test time=60sec/1pcs
- Wire range: 14-24AWG

Mechanical:

- Torque: 4.0kgf.cm/M3
- Operating temperature: -40°C to +105°C
- Soldring reliability: 5 seconds max
- Test temperature= 250°C±10°C

Ordering Information:

RoHS Compliant

TOLERANCES ARE

**MORETHANALL**  
PCB CONNECTORS  
Cable ASSEMBLIES

煜倫股份有限公司

www.morethanall.com

DRAWING BY CY

CHECKED BY GENIUS

UNIT / mm SCALE 1 : 1

DATE

SIZE A4

X. ±

.X ±

.XX ±

.XXX ±

ANG ±

PJECTION

照片框

ORDER INFORMATION

TBN050-D14BK-06-LF

SERIES

LEADFREE

06 WAY

BLACK

HIGH 14.5mm

DIP180°

DESCRIPTION: