

△ NOTES:

1. Rating: 300V 8A(IEC250V 10A)
PITCH: 5.00mm
2. Insulation Withstands Voltage:
AC 2000V/MIN
3. Insulation Resistance:
500MΩ or more at DC500V
4. Using Temperature Range:
-40°C~+105°C
5. Suitable Electric Wire:
26~14 AWG(IEC0.5~1.5mm²)
6. Torque Value: 5kgf-cm
7. Undimensioned Tolerances:

—	∩	∇	0.05/10
⊥	//	≡	0.2/10
PITCH ERROR			0.05/10
UNDIMENSIONS TOLERANCES			±0.3

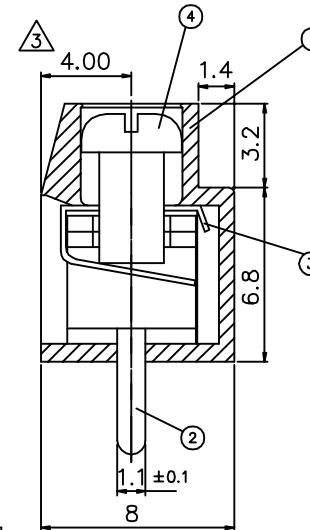
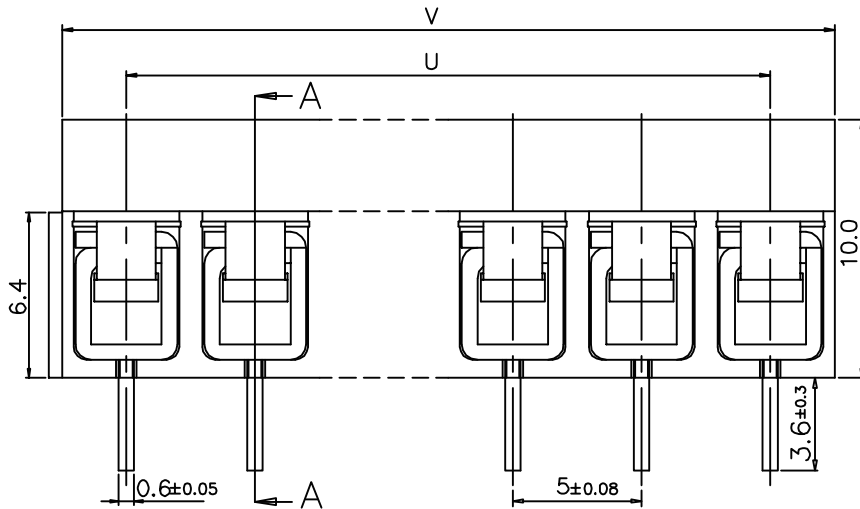
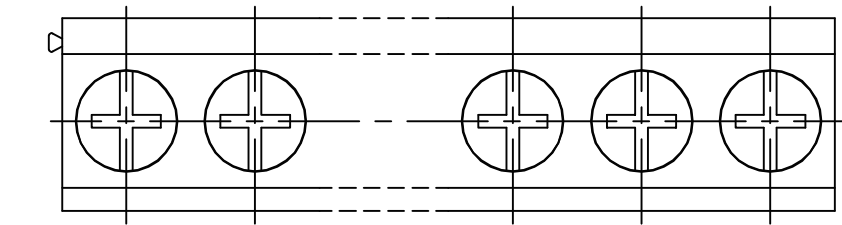

SECTION A-A

P	2	3	4	5	6	7	8	9	10	11	12	13	14	15	16	17	18	19
U	5.00	10.00	15.00	20.00	25.00	30.00	35.00	40.00	45.00	50.00	55.00	60.00	65.00	70.00	75.00	80.00	85.00	90.00
V	10.00	15.00	20.00	25.00	30.00	35.00	40.00	45.00	50.00	55.00	60.00	65.00	70.00	75.00	80.00	85.00	90.00	95.00
P	20	21	22	23	24	25	26	27	28	29	30	31	32	33	34	35	36	
U	95.00	100.00	105.00	110.00	115.00	120.00	125.00	130.00	135.00	140.00	145.00	150.00	155.00	160.00	165.00	170.00	175.00	
V	100.00	105.00	110.00	115.00	120.00	125.00	130.00	135.00	140.00	145.00	150.00	155.00	160.00	165.00	170.00	175.00	180.00	

Tolerances for PITCH ERROR

ITEM	NAME OF PART	NO. OF PAP	Q'TY	MATERIAL	NOTES
4	SCREW	S000004800	P	STEEL	ZINC PLATED
3	WIRE PROTECTOR	0012B00600	P	STAINLESS STEEL	
2	SOLDER POST	0012B00400	P	BRASS	SOLDER PLATED
1	HOUSING	0012L00000	1	PA66	GREEN

RoHS Compliant

TOLERANCES ARE

MORETHANALL
PCB CONNECTORS
Cable ASSEMBLIES

煜倫股份有限公司

www.morethanall.com

DRAWING BY CY

CHECKED BY GENIUS

UNIT / mm

SCALE 1 : 1

DATE

SIZE A4

X, ±

.X ±

.XX ±

.XXX ±

ANG ±

PPOJECTION

照片框

ORDER INFORMATION

TBN050-D10A-xx-LF

SERIES

LEADFREE

02~36WAY

A TYPE

HIGH 10.0mm

DIP180°

DESCRIPTION: