

# Technical Data:

## Material:

- Contact(metal housing): Brass Machined(option)
- Terminal screw: Steel galvanized and chromitized
- Solder Pin: Brass with Tin plated
- Insulator body(housing): Polyamide(Glass filled)(UL94V-0)

## Electrical

- Voltage rating: 300VAC
- Current rating: 20 Amps/way max
- Contact resistance: 20mΩ(max)
- Insulation resistance: 5000MΩ/1000V
- Withstanding Voltage: 2500VAC(1min) Test time=60sec/1pcs
- Wire range: 12-30AWG

## Mechanical:

- Torque: 4kgf.cm/M3
- Operating temperature: -30°C to +120°C
- Soldering reliability:  
Test temperature= 245°C±10°C  
5 seconds max

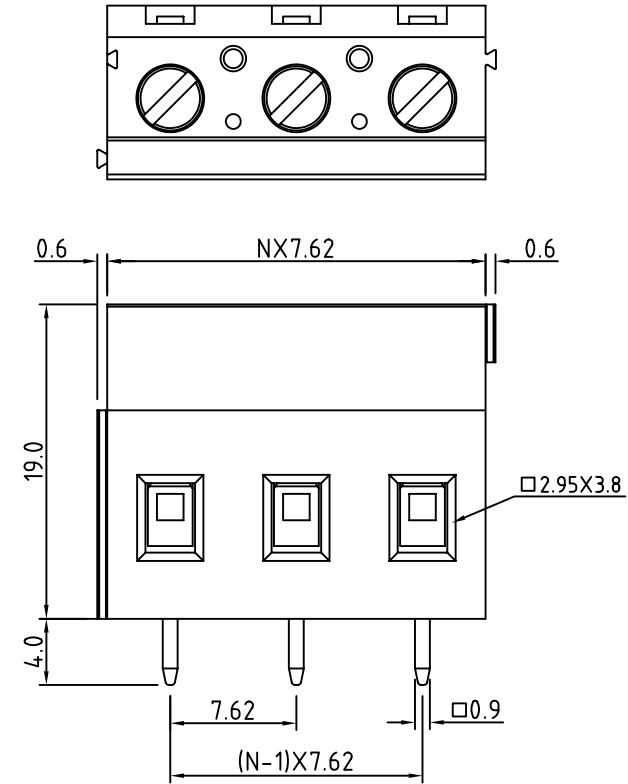

N=Number of contacts

## P.C.B LAYOUT

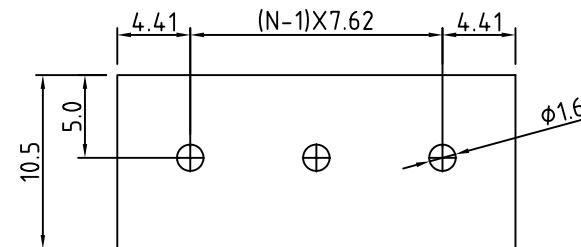

**MORETHANALL**  
PCB CONNECTORS  
Cable ASSEMBLIES

煜倫股份有限公司

www.morethanall.com

## RoHS Compliant

DRAWING BY CY

CHECKED BY GENIUS

UNIT / mm

SCALE 1 : 1

DATE

SIZE A4

PPOJECTION

## TOLERANCES ARE

X, ±  
.X ± 0.30  
.XX ± 0.10  
.XXX ±  
ANG ±



## ORDER INFORMATION

TBH076-D19-xx-LF

SERIES

LEADFREE  
02~24 WAY  
HIGH 19.0mm  
DIP 180°

DESCRIPTION: 7.62mm SERIES 180° 02P ~ 24P