

Material

- Item a Terminal body:Thermoplastic (UL94V-0)
- Item b Terminal body:Thermoplastic (UL94V-0)
- Item c Terminal screw:Steel Zinc plating "-" slot type
- Item d Clamp:Brass, Ni plated
- Item e Female contact:PhBz (CuSn) Tin plated

Electrical cULus/TUV

- Voltage rating: 300VAC/750VAC
- Current rating: 15A/15A
- Wire range:0.2-2.5mm²
- Solid wire(AWG): 12-24
- Stranded wire(AWG): 12-24
- Torque: 3.5 Lb-In 0.4Nm
- Screw: M3
- Wire strip length: 6-7mm
- Withstanding Voltage: 1.6KV/6KV
- Operating temperature: -40°C to +115°C
- Safety Approval: cULus TUV

DimA=(N-1)×7.5+5.6

DimB=(N-1)×7.5

N=Number of contacts

POLES	DIM A	DIM B
2p-6p	±0.20	±0.20
7p-11p	±0.30	±0.30
12p-16p	±0.40	±0.40

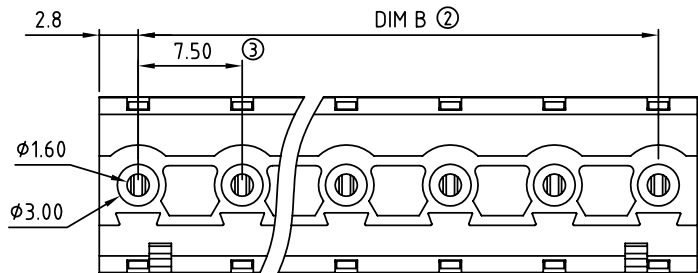

RoHS Compliant

TOLERANCES ARE

MORETHANALL
PCB CONNECTORS
Cable ASSEMBLIES

DRAWING BY CY

CHECKED BY GENIUS

UNIT / mm

SCALE 1 : 1

DATE

SIZE A4

X, ±
.X ±
.XX ±
.XXX ±
ANG ±

P PROJECTION

照片框

ORDER INFORMATION

TBH075-SVB-xx-LF

SERIES

LEADFREE

02-16WAY

BOTTOM SIDE

SCREW 180°

FEMALE

煜倫股份有限公司

www.morethanall.com

DESCRIPTION: