

N= Number of poles
 Dim.B= (N-1)x12.7
 Dim.L= (N-1)x12.7+15.24

POLE	2P- 8P	9P- 14P	15P- 20P
Dim.B	±0.20	±0.30	±0.40
Dim.L	±0.30	±0.40	±0.60

MATERIALS ELECTRICAL

- RATED VOLTAGE & CURRENT: 600 V, 45A
 WITHSTAND VOLTAGE: AC 2500 V/Min
 INSULATION RESISTANCE: 1000 MΩ OR MORE AT DC 500 V
 OPERATING TEMPERATURE RANG: -40 °C ~ +115 °C
 SCREW TORQUE VALUE: 18 Kgf.cm
 WIRE RANGE: 18 - 8 AWG
 1) BODY: THERMOPLASTICS, UL94-V0 BLACK
 2) TERMINAL: BRASS, 1.6t, Tin PLATED
 3) TERMINAL SCREWS WITH WASHER: STEEL, Ni PLATED, M4.0

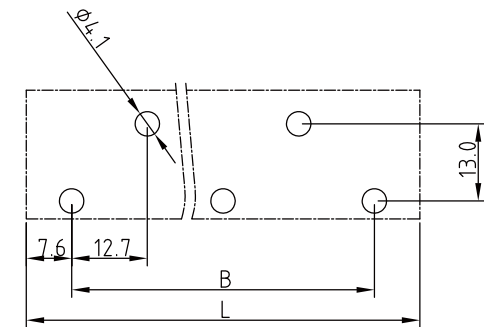

P.C.B LAYOUT

RoHS Compliant

TOLERANCES ARE

MORETHANALL
 PCB CONNECTORS
 Cable ASSEMBLIES

煜倫股份有限公司

www.morethanall.com

DRAWING BY CY

CHECKED BY GENIUS

UNIT / mm SCALE 1 : 1

DATE

SIZE A4

X, ±
 .X ±
 .XX ±
 .XXX ±
 ANG ±

P PROJECTION

照片框

ORDER INFORMATION

TBC127-D-xx-LF
 SERIES | LEADFREE
 02~20WAY
 DIP 90°

DESCRIPTION: