

Materials Electrical:

- Rated: 250V 15A
- Insulation Withstands Voltage: AC2000V/min
- Insulation Resistance: 1000MΩ or More at DC500V
- Using Temperature Rang: -40°C~+105°C
- Screw Torque Value: 6Kg-cm
- Suitable Electric Wire: 22~16 AWG
- 1) Molded Parts: Polyamide 66 UL94V-0 Black
- 2) Terminal: Brass 0.8t Tin Plated
- 3) Terminal Screws: Steel M3 Ni Plated

P.C.B LAYOUT

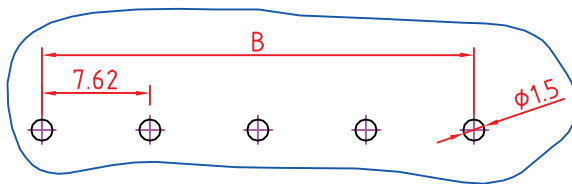

| | | | | | | | | | | | | | | | |
|------|--------|--------|--------|--------|--------|--------|--------|--------|--------|--------|--------|--------|--------|--------|--------|
| POLE | 1 | 2 | 3 | 4 | 5 | 6 | 7 | 8 | 9 | 10 | 11 | 12 | 13 | 14 | 15 |
| A | | 16.74 | 24.36 | 31.98 | 39.60 | 47.22 | 54.84 | 62.46 | 70.08 | 77.70 | 85.32 | 92.94 | 100.56 | 108.18 | 115.80 |
| B | | 7.62 | 15.24 | 22.86 | 30.48 | 38.10 | 45.72 | 53.34 | 60.96 | 68.58 | 76.20 | 83.82 | 91.44 | 99.06 | 106.68 |
| POLE | 16 | 17 | 18 | 19 | 20 | 21 | 22 | 23 | 24 | 25 | 26 | 27 | 28 | 29 | 30 |
| A | 123.42 | 131.04 | 138.66 | 146.28 | 153.90 | 161.52 | 169.14 | 176.76 | 184.38 | 192.00 | 199.62 | 207.24 | 214.86 | 222.48 | 230.10 |
| B | 114.30 | 121.92 | 129.54 | 137.16 | 144.78 | 152.40 | 160.02 | 167.64 | 175.26 | 182.88 | 190.50 | 198.12 | 205.74 | 213.36 | 220.98 |

RoHS Compliant

TOLERANCES ARE

MORETHANALL
PCB CONNECTORS
Cable ASSEMBLIES

DRAWING BY CY

CHECKED BY GENIUS

UNIT / mm

SCALE 1 : 1

DATE

SIZE A4

P PROJECTION

X, ±
.X ±
.XX ±
.XXX ±
ANG ±

照片框

ORDER INFORMATION

TBB076-D-xx-LF

SERIES

LEADFREE

02~30WAY

DIP 180°

煜倫股份有限公司

www.morethanall.com

DESCRIPTION: