

Specifications

Contact Resis 30mΩ max. at DC 100mA  
 Insulator Resistance: 1000MΩ min. at DC 500V  
 Current Rating: 1 AMP

Dielectric Withstanding

Voltage: AC 500V For 1 minute  
 Operating Temperature: -55° C ~ +105° C  
 Contact: Beryllium Copper  
 Housing: PPS & 30% Glass Fiber (UL 94V-0)

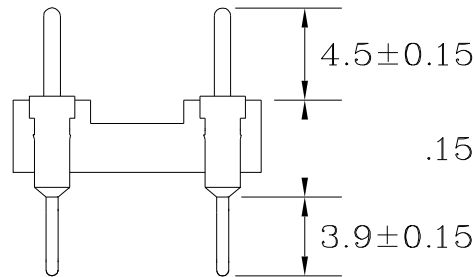
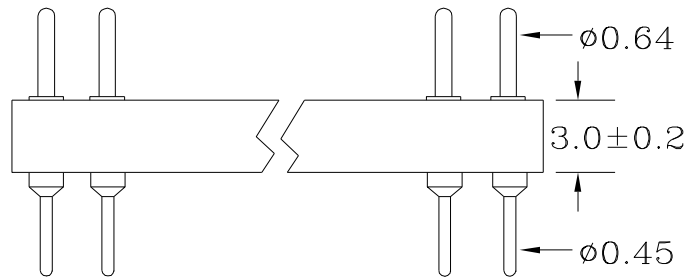

Position /03	Dimension (mm)			
	A	B	有桿	無桿
6	5.03	7.62		✓
8	7.62	10.16		✓
10	10.16	12.70		✓
12	12.70	15.24		✓
14	15.24	17.78		✓
16	17.78	20.32		✓
18/E	20.32	22.86		✓
18	20.32	22.86	✓	
20	22.86	25.45	✓	
22	25.45	27.94	✓	
24	27.94	30.60	✓	
28	33.02	35.56	✓	
32	38.10	40.62	✓	

RoHS Compliant

TOLERANCES ARE

**MORETHANALL**  
 PCB CONNECTORS  
 Cable ASSEMBLIES

煜倫股份有限公司

www.morethanall.com

DRAWING BY CY

CHECKED BY GENIUS

UNIT / mm SCALE 1:1

DATE

SIZE A4

X.±  
 .X±  
 .XX±  
 .XXX±  
 ANG±

PJECTION

照片框

ORDER INFORMATION

SPIC-D03-xx-LF  
 SERIES | | LEADFREE  
 | | 06-32WAY  
 | | SPACING 7.62mm  
 | | DIP 180°

DESCRIPTION: IC SOCKET MACHINED PIN ROW TO ROW: 7.62