

SECTION A-A

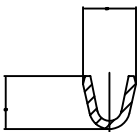

SECTION B-B

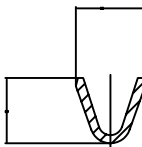

SECTION C-C

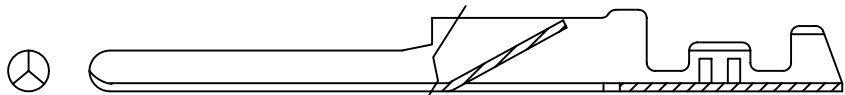

備註/NOTE:

1. 材質/MATERIAL: 磷銅
2. 厚度/THICKNESS: 0.2mm
3. 電鍍/PLATING: 亮錫 60u"/TIN 60u"
4. 適用於 ON-JG0006 ~ ON-JG0008 (HOUSING) SERIES
5. 不可壓傷變形
6. 表面光亮
7. 不可刮傷露銅

**MORETHANALL**  
CONNECTORS  
ASSEMBLIES

煜倫有限公司

PART NO. SN-M

DWG NO. SN-M

FILE NO. OY-JG0001

UNIT / mm

SCALE 1:1

APPROVED BY CY

DRAWING BY

PROJECTION

TOLERANCES ARE

.X ± 0.1

.XX ± 0.05

.XXX

AWG

DESCRIPTION: SONY 端子(錫)

AREA

REVISIONS

HK

DATE