

1. CRIMPED FERRULE HEX CRIMP SIZE .151"
2. CONTACT PIN TO SOLDER

NOTES: FINISH (PLATING THICKNESS IN MICRO-INCHES)

1. GOLD PL 3 MIN OVER NICKEL PL 70 MIN TRICK OVER COPPER STRIKE
2. GOLD PL 30 MIN OVER NICKEL PL 70 MIN TRICK OVER COPPER STRIKE

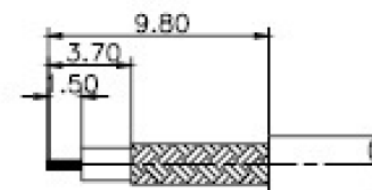
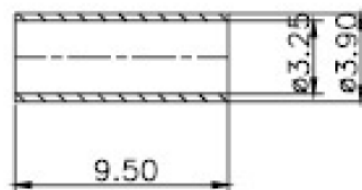

RECOMMENDED  
CABLE STRIPPING DIM'S

|      |             |           |      |          |
|------|-------------|-----------|------|----------|
| 7    | FERRULE     | BRASS     | 1    | NOTE1    |
| 6    | COVER       | BRASS     | 1    | NOTE1    |
| 5    | HOUSING     | BRASS     | 1    | NOTE1    |
| 4    | CONTACT PIN | Be,Copper | 1    | NOTE2    |
| 3    | INSULATOR   | TEFLON    | 1    | WHITE    |
| 2    | BODY        | BRASS     | 1    | NOTE1    |
| 1    | SHELL       | BRASS     | 1    | NOTE1    |
| ITEM | DESCRIPTION | MATERIAL  | Q'TY | FINISHED |

RoHS Compliant

TOLERANCES ARE

**MORETHANALL**  
PCB CONNECTORS  
Cable ASSEMBLIES

煜倫股份有限公司

www.morethanall.com

DRAWING BY CY

CHECKED BY GENIUS

UNIT / mm SCALE 1:1

DATE

SIZE A4

X, ±

.X ±

.XX ±

.XXX ±

ANG ±

P PROJECTION

照片框

ORDER INFORMATION

SMC-PCR-174-LF  
SERIES | | LEADFREE  
| | RG 174  
| 90°  
| CRIMP  
| MALE

DESCRIPTION: