

NOTES: TYPICAL SPECIFICATIONS

1.0. ELECTRICAL DATA

- 1.1. FREQUENCY RANGE ---- DC ... 6 GHz
- 1.2. IMPEDANC ---- 50 Ohms
- 1.3. VSWR ---- < 1.25
- 1.4. DIELECTRIC WITHSTANDING VOLTAGE ---- 500 Vrms
- 1.5. INSULATION RESISTANCE ---- 1000 Mega-Ohms
- 1.6. CENTER CONTACT RESISTANCE ---- 10.0 mini-Ohms
- 1.7. OUTER CONTACT RESISTANCE ---- 6.0 mini-Ohms

2.0. MECHANICAL DATA

- 2.1. COUPLING METHOD ---- THREADED
- 2.2. DURABILITY (MATING/UNMATING) ---- 500 Cycles

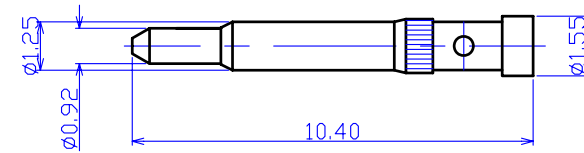
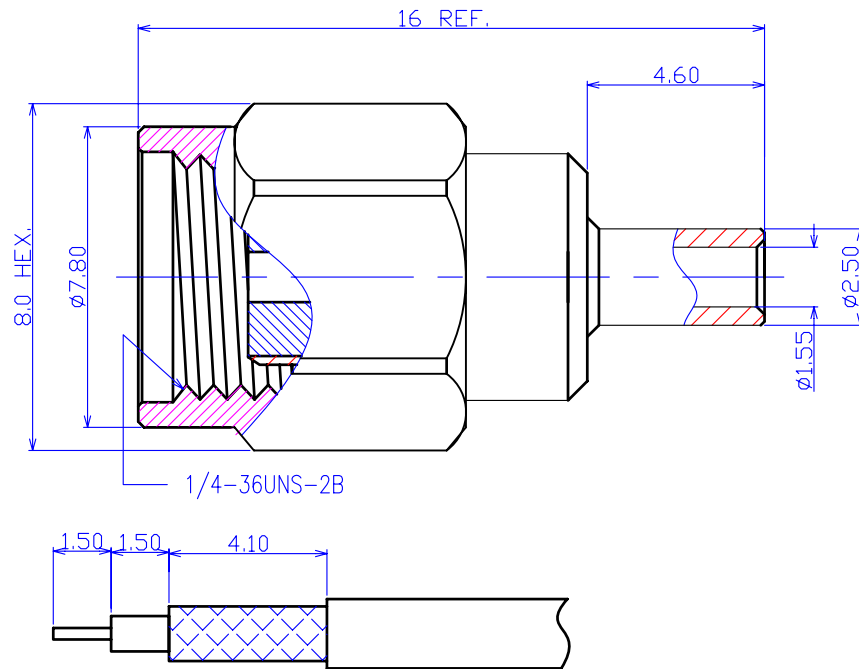

Recommended Cable Strip

4	MALE CONDUCTOR	BRASS	GOLD 10u"	1
3	MALE INSULATOR	TEFLON		1
2	MALE BODY	BRASS	GOLD	1
1	SHELL	BRASS	GOLD	1
ITEM	ITEM NAME	MATERIAL	FINISH	Q'TY/EA

RoHS Compliant

TOLERANCES ARE

MORETHANALL
PCB CONNECTORS
Cable ASSEMBLIES

DRAWING BY CY

X. \pm

CHECKED BY GENIUS

.X \pm

UNIT / mm

SCALE 1 : 1

.XX \pm

DATE

.XXX \pm

ANG \pm

SIZE A4

PPOJECTION

照片框

ORDER INFORMATION

SMA-PC-178-LF
SERIES | LEADFREE
RG 178
CRIMP
MALE

煜倫股份有限公司

www.morethanall.com

DESCRIPTION: SMA PLUG STR. FOR RG 178/u