

RECOMMENDED LAYOUT
MATING PCB SIDE

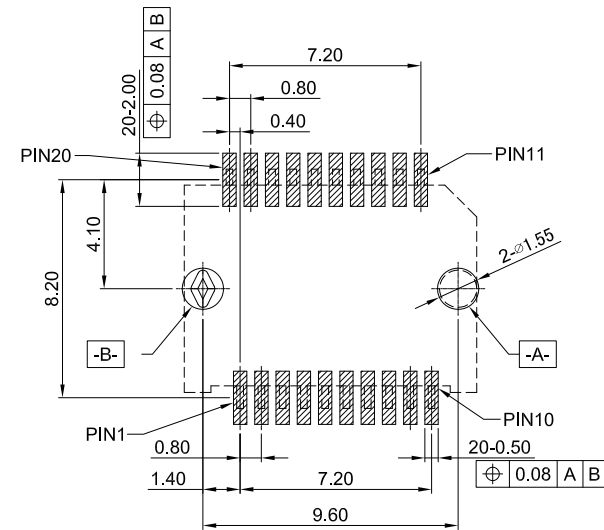

RECOMMENDED PCB LAYOUT(TOP VIEW)

NOTES:

- 1.MATERIAL:
HOUSING: LCP UL94V-0,BLACK
CONTACT: C5210R-EH, t=0.20mm
- 2.DURABILITY TEST:100 CYCLES MIN.
- 3.SPECIFICATION:
DIELECTRIC STRENGTH: AC 300V/MINUTE
INSULATOR RESISTANCE: 500 Mohm MIN
CONTACT RESISTANCE: 40 mohm Max.
OPERATING TEMPERATURE: -40°~+85°

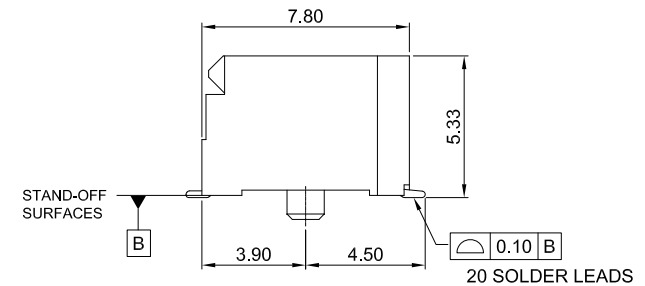

RoHS Compliant

TOLERANCES ARE

MORETHANALL
PCB CONNECTORS
Cable ASSEMBLIES

DRAWING BY CY

CHECKED BY GENIUS

UNIT / mm

SCALE 1 : 1

DATE

SIZE A4

P PROJECTION

Up to 5 ±0.2
Above 5~15 ±0.3
Above 15~30 ±0.4
Above 30~50 ±0.5
Angle ±0.3°

照片框

ORDER INFORMATION

SFP-SWP-20-LF
SERIES | LEADFREE
| 20WAY
| POST
| 90°SMT
| FEMALE

DESCRIPTION: SFP+ 20PIN BLACK R/A SMT 2POSTS

煜倫股份有限公司

www.morethanall.com