

PIN DEFINE	
PAD NO.	MEMORY CARD
SD-01	SD-CD/DAT3
SD-02	SD-CMD
SD-03	SD-VSS
SD-04	SD-VDD
SD-05	SD-CLK
SD-06	SD-VSS
SD-07	SD-DAT0
SD-08	SD-DAT1
SD-09	SD-DAT2

ITEM 項目	PARTS NAME 零件名稱	Q'TY 數量	MATERIAL 材質	FINISH/REMARK 處理/備註
1	HOUSING	1	SYNTHETIC RESIN	BLACK
2	SHELL	1	STAINLESS	-
3	CONTACT-SD	1	COPPER ALLOY	5u"MIN. GOLD PLATING ON CONTACT AREA 80~100u"MIN. TIN PLATING 50u"MIN. NICKEL UPDERPLATING OVERALL
4	SLIDER CAM	1	SYNTHETIC RESIN	BLACK
5	CAM PIN	1	STAINLESS	-
6	SPRING	1	STAINLESS	-
7	DETECT CONTACT	1	COPPER ALLOY	5u"MIN. GOLD PLATING ON CONTACT AREA 80~100u"MIN. TIN PLATING
8	PROTECT CONTACT	1	COPPER ALLOY	50u"MIN. NICKEL UPDERPLATING OVERALL
9	SW CONTACT	1	COPPER ALLOY	5u"MIN. GOLD PLATING ON CONTACT AREA 1u"MIN. GOLD PLATING ON CONTACT TAIL 50u"MIN. NICKEL UPDERPLATING OVERALL
10	GND CONTACT	1	COPPER ALLOY	80~100u"MIN. TIN PLATING 50u"MIN. NICKEL UPDERPLATING OVERALL

POSITION OF CARD	WITHOUT CARD	CARD INSERTED WRITE PROTECT : LOCK	CARD INSERTED WRITE PROTECT : UNLOCK
CIRCUIT	WP SW	WP SW	WP SW
	CD SW	CD SW	CD SW

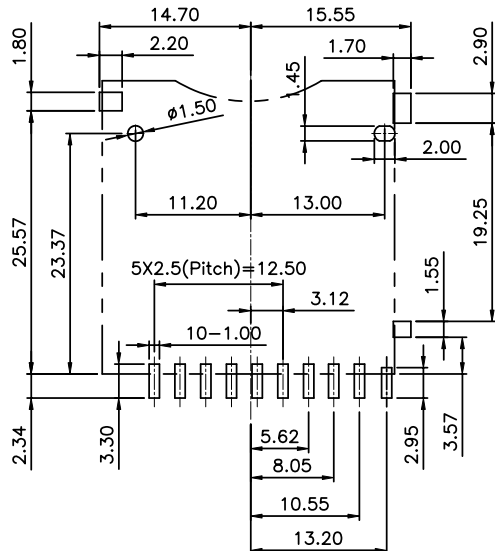
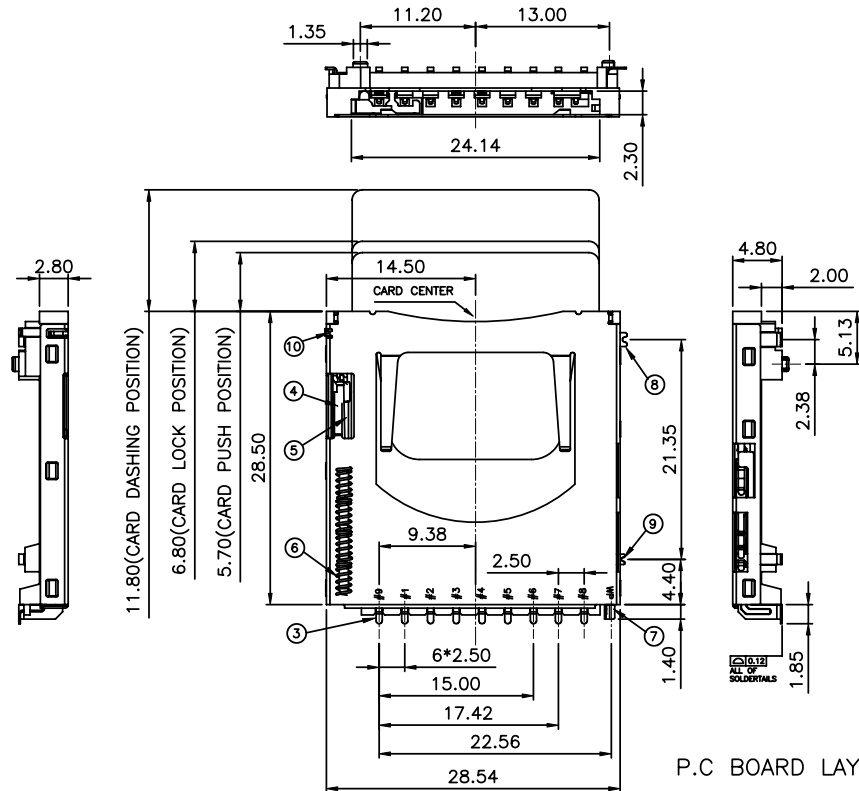

SPECIFICATION
 MATERIAL
 See drawing
 STANDARD DATA
 Rating current:0.5A
 Operating temperature: -35°C ~ +85°C
 Storage temperature: -40°C ~ +90°C
 ELECTRICAL
 Insulator resistance: 1000M ohms Min. @ 100V DC
 Withstanding voltage: 500V AC/minute
 Contact resistance: 100 m ohms Max.
 MECHANICAL
 INSERTION FORCE: 40N(4.08kgf) MAX.
 WITHDRAWAL FORCE: 2.0(0.21kgf) MIN.
 Durability: 10000 cycles Min.
 Contact retention force: 2.45N(0.25kgf) Min

P.C BOARD LAYOUT (TOLERANCE: ±0.02mm)

RoHS Compliant

煜倫股份有限公司

www.morethanall.com

DRAWING BY CY		TOLERANCES ARE X. ± 0.50 .X ± 0.30 .XX ± 0.20 .XXX ± ANG ± 5°
CHECKED BY GENIUS		
UNIT / mm	SCALE 1 : 1	
DATE		
SIZE A4	P PROJECTION	



ORDER INFORMATION

SDC-W24PB20B20-09-LF

SERIES | | | | | LEADFREE

90°SMT | | | | | 09WAY

POST TO POST 24.0mm | | | | | 2.0mm STANDOFF

B TYPE | | | | | EAR/POST 2.45mm

PUSH PUSH

DESCRIPTION: SD CONN STAND OFF 2.0MM