

- Material: Brass
- Finished: Tin-plated
- Wire range: AWG #24 ~ #28
- Thickness: 0.2mm
- Applicable P.C.B. thickness: .047" ~ .063"
(1.2mm ~ 1.6mm)

Specification:

- Current rating: 3A AC,DC
- Voltage rating: 250V AC,DC
- Dielectric withstanding voltage: 800V AC/minute
- Ambient temperature range: -25°C ~ 85°C

SCB-T-24-LF
LEADFREE
RoHS Compliant

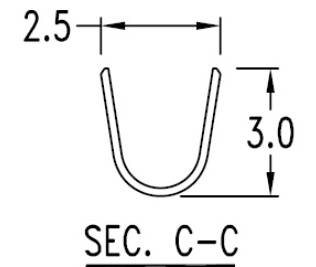
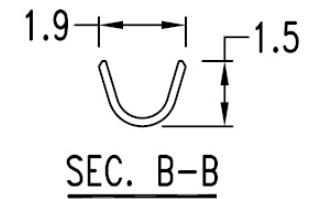
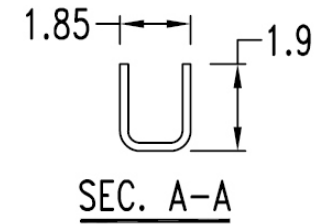
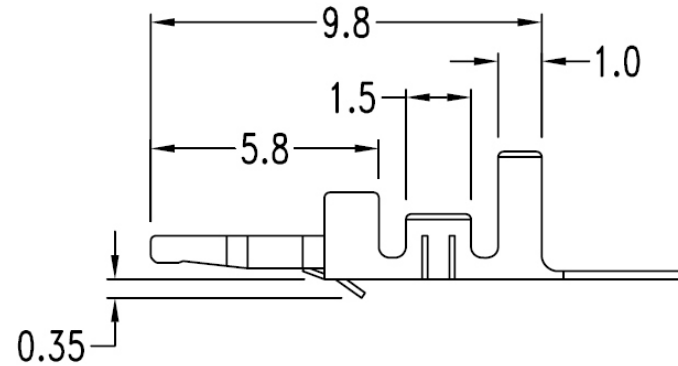
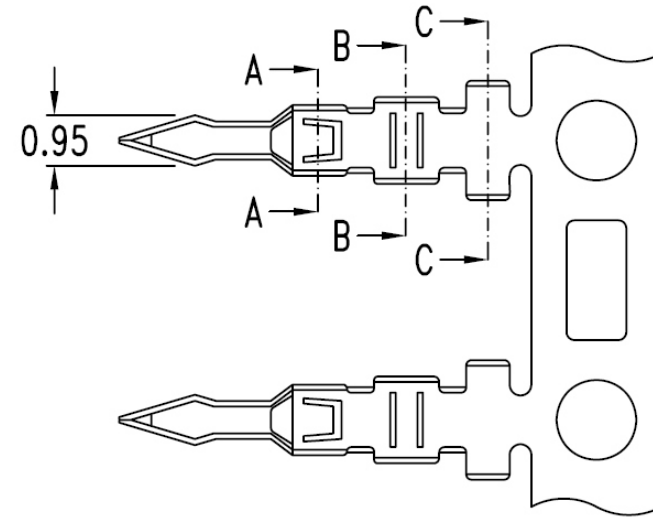

PART NO. **SCB-T-24**

DWG NO. **SCB-T-24**

FILE NO.

UNIT / mm

SCALE 1:1

CHECKED BY CY

DRAWING BY

PROJECTION

TOLERANCES ARE

.X ± 0.2
.XX ±
.XXX ±
AWG

DESCRIPTION:

AREA

REVISIONS

HK

DATE

煜倫股份有限公司