

- NOTES:
1. MATERIALS
 - 1.1 Insulator: Pc
 - 1.2 Contact: Brass 0.2T
 - 1.3 Material sheel: SPCC 0.5T
 - 1.4 Contact Plating: TIN Plated
 2. SPECIFICATIONS
 - 2.1 Current Rating: 5Amp
 - 2.2 Dielectric Strength: 1000V AC for one minute
 - 2.3 Insulator Resistance: 5000M Ohms Min.(at 500V DC)
 - 2.4 Operation Temperature: -55°C to +105°C

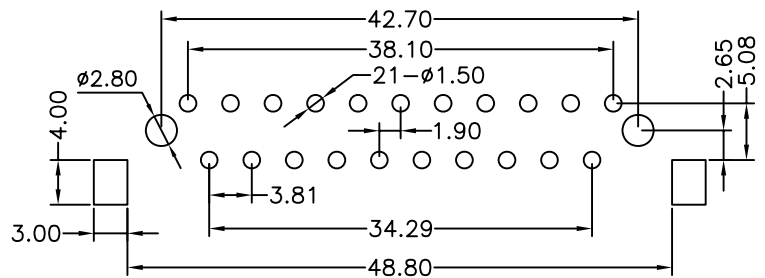

SC-SRLMH-21-LF
LEADFREE

RoHS Compliant



PART NO. SC-SRLMH-21		CHECKED BY CY		TOLERANCES ARE .X±0.3 .XX±0.2 .XXX± AWG	DESCRIP TION: 90度母座有柱有孔錫 PC加鐵殼(有凸)			
DWG NO. SC-SRLMH-21		DRAWING BY			AREA	REVISIONS	HK	DATE
FILE NO.		PROJECTION						
UNIT / mm	SCALE 1:1							

煜倫股份有限公司