

Signal Segment		Power Segment			
Name	Type	Name	Type	Name	Type
S1	GND	P1	V33	P9	V5
S2	A+	P2	V33	P10	GND
S3	A-	P3	V33	P11	DAS/DSS
S4	GND	P4	GND	P12	GND
S5	B-	P5	GND	P13	V12
S6	B+	P6	GND	P14	V12
S7	GND	P7	V5	P15	V12
		P8	V5		

NOTES:

***Material**
 Housing: LCP, UL 94V-0 rated;
 Color: Black.
 Contact: Phosphor Bronze
 Plating: Gold Plating over Nickel on contact area Tin plating on solder Tail.

***Mechanical**
 Insertion Force: 45N max.
 Withdrawal Force: 10N min.
 Durability: 500 cycles

***Electrical Specification**
 Current Rating: 1.5 Ampere per contact
 Contact Resistance: 30 Milliohms max.
 Insulation Resistance: 1000 Megohms min.
 Dielectric Withstanding Voltage: 500 VAC

***Environmental**
 Operating Temperature: 0°C to +85°C

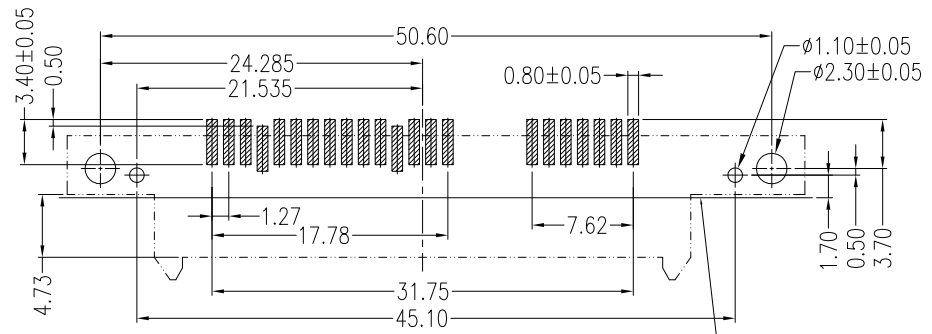
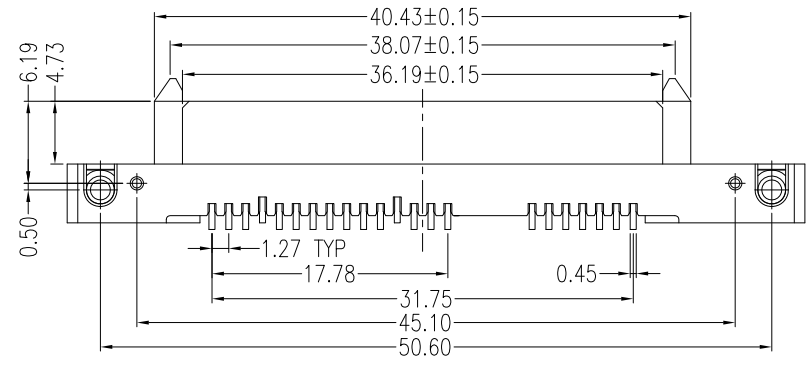
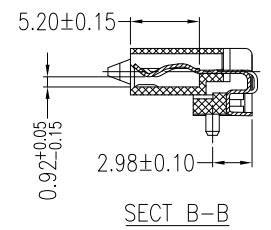
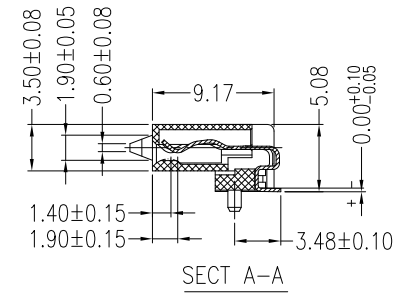

RECOMMEND P.C.B LAYOUT(T=1.2mm)
 TOP VIEW

SATA-SW50EP05-15+7-LF
 LEADFREE
 RoHS Compliant



PART NO. SATA-SW50EP05-15+7

DWG NO. SATA-SW50EP05-15+7

FILE NO.

CHECKED BY CY

DRAWING BY

TOLERANCES ARE
 .X ± 0.2
 .XX ±
 .XXX ±
 AWG

DESCRIPTION:

S ATA 7+15P Female SMT Type
 (None Vibration)

焯倫股份有限公司

UNIT / mm

SCALE 1:1

PROJECTION

AREA

REVISIONS

HK

DATE