

NOTE :

- * Material : PBT, UL 94V-0
- * Electrical rating : UL 30V 8.3A, AC/DC
CSA 30V 3.5A, AC/D
- * Color : Black
- * Applicable wire AWG #16- #24

PART NO.	AWG NO.	MARK
SATA-ST16L-15	#16	16
SATA-ST18L-15	#18	18
SATA-ST20L-15	#20	20
SATA-ST22L-15	#22	22
SATA-ST24L-15	#24	24

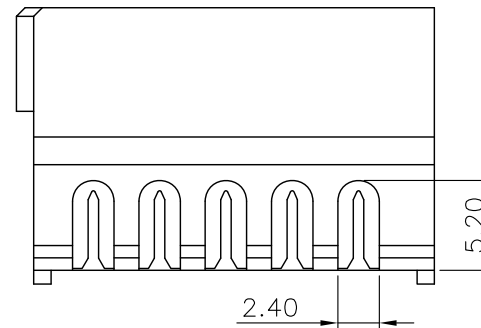
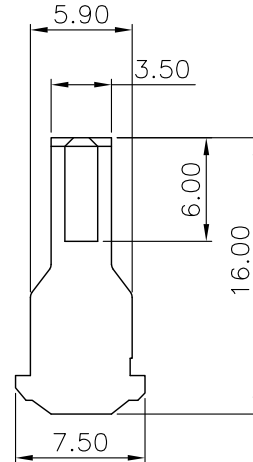
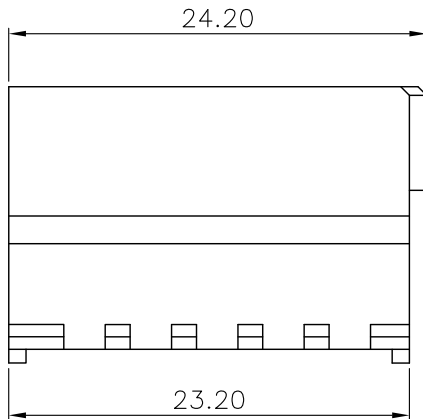
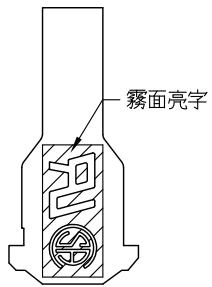

SATA-STxxL-15-LF
LEADFREE
RoHS Compliant

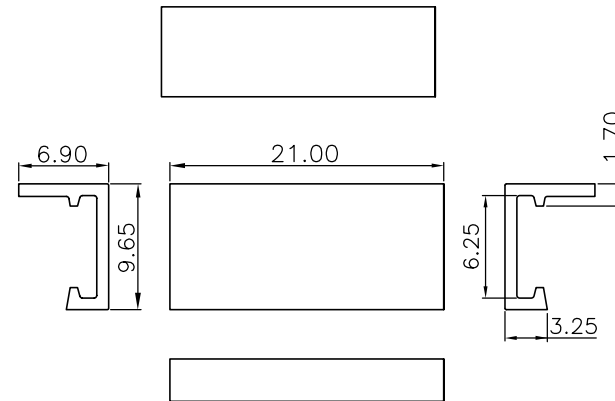
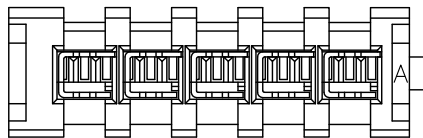

NOTE :

- * Material : Nylon, UL 94V-2
- * Electrical rating : UL 30V 8.3A, AC/DC
CSA 30V 3.5A, AC/DC
- * Color : Black

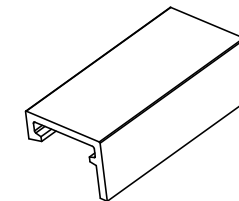

MORETHANALL
CONNECTORS
ASSEMBLIES

PART NO. SATA-STxxL-15

DWG NO. SATA-STxxL-15

CHECKED BY CY

TOLERANCES ARE

DESCRIP TION:

FILE NO.

DRAWING BY

.X ± 0.2

.XX ±

.XXX ±

AWG

AREA

REVISIONS

HK

DATE

焯倫股份有限公司

UNIT / mm

SCALE 1:1

PROJECTION

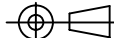

A

B

C

D

E

F

G

H

I

J

1

2

3

4

5

6

7

8

9

0