

SHORT COVER

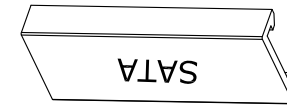

SHORT COVER

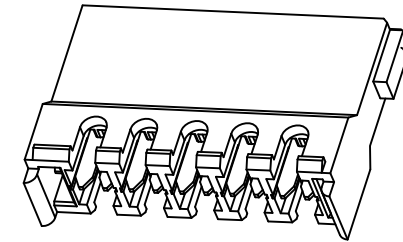
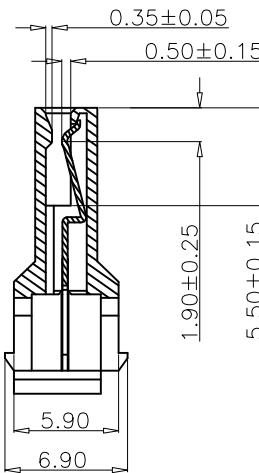
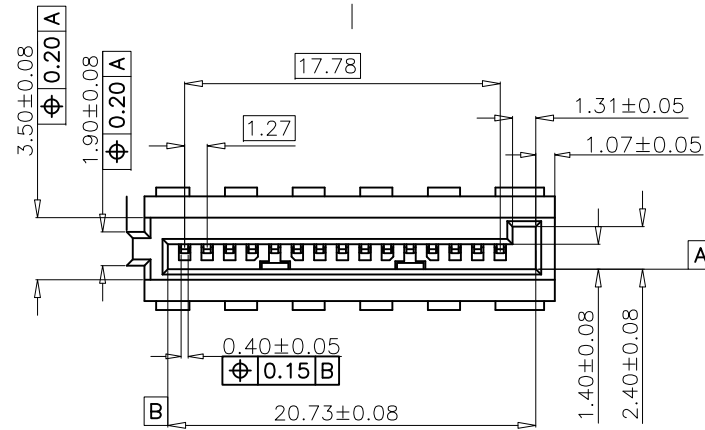

SECTION A-A  
SCALE 1 : 1

NOTES:

- 1.MATERIAL:  
BASE&COVER:HIGH TEMPERATURE THERMOPLASTIC,UL94 V-0,  
COLOR:BLACK  
CONTACT:COPPY ALLOY T=0.30±0.01mm  
SPRING:STAINLESS STEEL T=0.20±0.01mm
- 2.PLATING:  
CONTACT:GOLD OVER PLATED UNDERPLATE TERMINAL AREA,100u"MIN  
TIN OVER PLATED SOLDER TAIL AREA 50u" MIN NICKEL UNDERPLATE  
GOLD SPECIFICATION:a, G/F; b, 15u"
- 3.ELECTRONICAL SPECIFICATION:  
CURRENT RATING:1.5 AMPERE PER CONTACT  
CONTACT RESISTANCE:30 MILLIOHMS MAX.  
INSULATION RESISTANCE:1000 MEGOHMS MIN.  
DIELECTRIC WITHSTANDING VOLTAGE:500 VAC.  
OPERATING TEMPERATURE:-20°C~+85°C
- 4.THE PRODUCT SHOULD BE GP COMPLIANCE

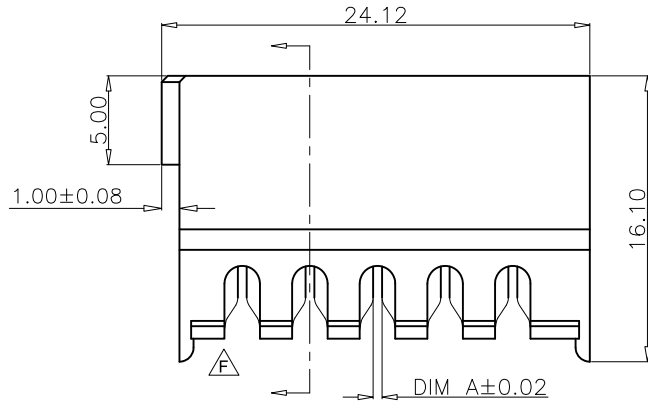

SATA-ST18C-15-LF  
LEADFREE

RoHS Compliant



PART NO. SATA-ST18C-15

DWG NO. SATA-ST18C-15

FILE NO.

CHECKED BY CY

DRAWING BY

TOLERANCES ARE

- X. ±
- .X ± 0.2
- .XX ± 0.15
- .XXX ±
- ANG

DESCRIPTION:

ASSEMBLY OF SATA-15P IDC  
(FULL PIN)--NEW YTYPE

焯倫股份有限公司

UNIT / mm

SCALE 1:1

PROJECTION

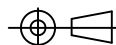

AREA

REVISIONS

DATE