

Pin Number	Signal Name	Pin Number	Power Line Designation
S1	GND	P1	DP
S2	A+	P2	+5V
S3	A-	P3	+5V
S4	GND	P4	MD
S5	B-	P5	GND
S6	B+	P6	GND
S7	GND		

Notes:

***Material**

Housing: LCP, UL94 V-0; Color: Black
 Contact: Brass
 Plating: Au Plating On Contact Area;
 Sn(100u" Min.) Plating On Solder Tail;
 Ni(40u" Min.) Underplating Overall
 Harpoon: Brass
 Plating: Sn(100u"Min) Plating Overall;
 Ni(50u" Min.) Underplating Overall

***Mechanical**

Insertion Force: 45N max.
 Withdrawal Force: 10N min.
 Durability: 500 cycles

***Electrical Specification**

Current Rating: 1.5 Ampere per contact
 Contact Resistance: 30mΩ Max.
 Insulation Resistance: 1000MΩ Min.
 Dielectric Withstanding Voltage: 500V AC

***Environmental**

Operating Temperature: -55°C to +85°C

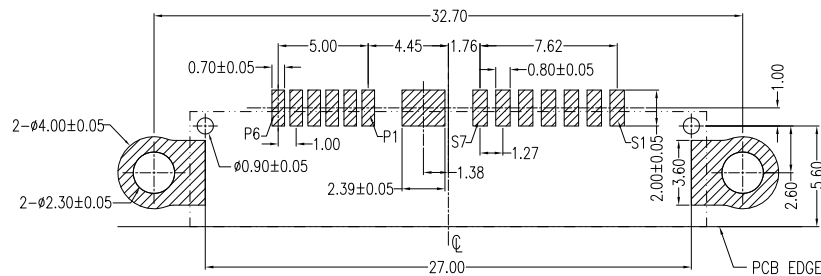
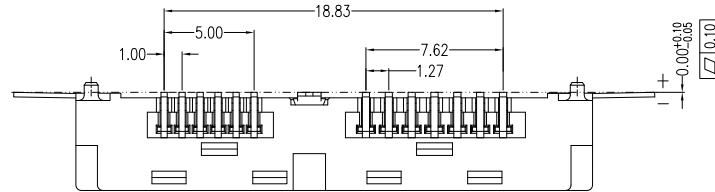
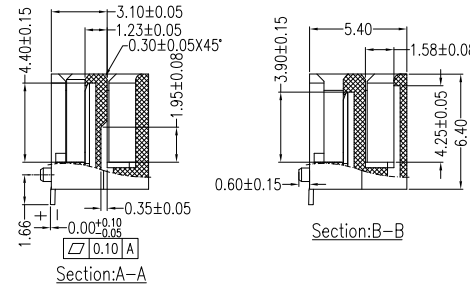
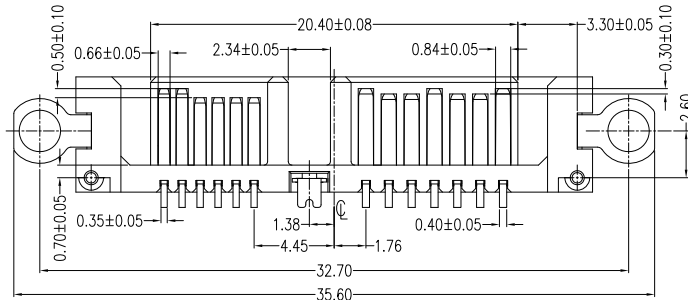

P.C.B LAYOUT(T=1.60mm)
 COMPONENT SIDE

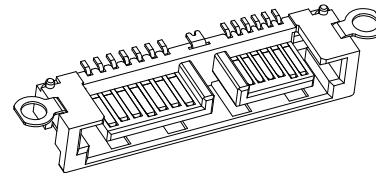

RoHS Compliant

TOLERANCES ARE

MORETHANALL
 PCB CONNECTORS
 Cable ASSEMBLIES

DRAWING BY CY

CHECKED BY GENIUS

UNIT / mm

SCALE 1 : 1

DATE

SIZE A4

PJECTION

X, ±
 .X ± 0.35
 .XX ± 0.25
 .XXX ± 0.15
 ANG ± 3°

照片框

ORDER INFORMATION

SATA-PWA-6+7-LF

SERIES | | | LEADFREE
 | | | 6+7 WAY
 | | | UPPER CONTACT
 | | | 90°SMT
 | | | MALE

DESCRIPTION: Slimline S ATA 7+6P R/A SMT Male

煜倫股份有限公司

www.morethanall.com