

Dim.C	NOTE
4.00mm	02~20pins
8.05mm	21~40pins

Specifications

Current Rating:2Amp

Insulation Resistance:1000M Ω Min.

Dielectric Withstanding Voltage500VAC

Contact Resistance:20m Ω Max.

Operating Temperature:-40°C to +105°C

Materials

Contact Material:Phosphor Bronze

Insulator Material:High Temperature

Thermoplastic, UL 94V-0 Nylon 6T(Halogen Free) or the equivalent material

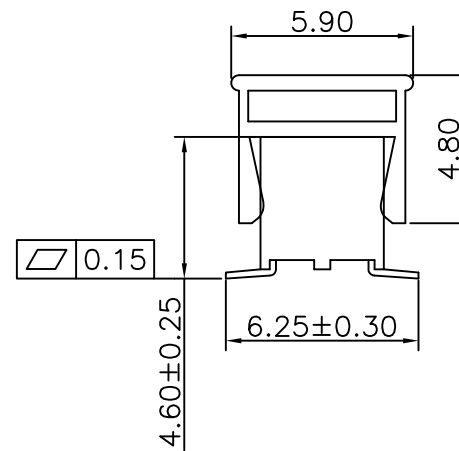
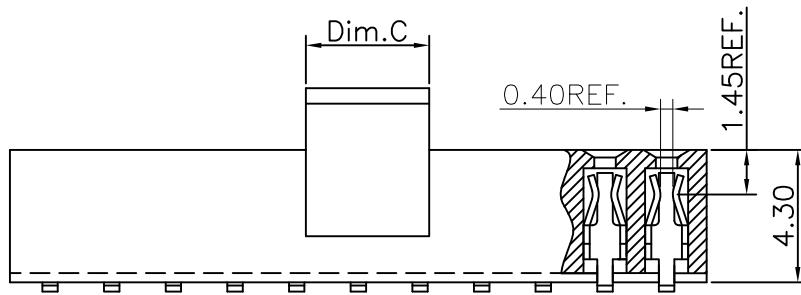

Recommended P.C.Board Layout
For Top Entry
(Tolerance: ± 0.05)

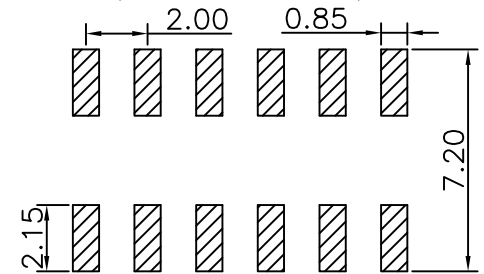

RoHS Compliant

TOLERANCES ARE

MORETHANALL
PCB CONNECTORS
Cable ASSEMBLIES

煜倫股份有限公司

www.morethanall.com

DRAWING BY CY

CHECKED BY GENIUS

UNIT / mm

SCALE 1 : 1

DATE

SIZE A4

P PROJECTION

X. ± 0.30

.X ± 0.25

.XX ± 0.15

.XXX ± 0.10

ANG \pm

照片框

ORDER INFORMATION

S-V46XC-2Xxx-LF

SERIES | LEADFREE
180°SMT | 2X02:04WAY
HIGH 4.60mm | 2X40:080WAY
CAP | NON POST

DESCRIPTION: 2.0 FEMALE HEADER DUAL ROW SMT TYPE BASE 4.30 H