

SPECIFICATIONS

- * Current Rating : 1 Amps
- * Insulator resistance: 5000 Megohms min.
- * Dielectric withstanding: AC 500 V
- * Operating Temperature: -40° $-+105^{\circ}$ C
- * Max Processing Temp: 230° for 30~60 seconds
(260° for 10 seconds)
- * Contact Material: Phosphor bronze
- * Housing: L.C.P (UL 94 V-0)

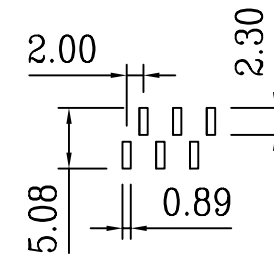
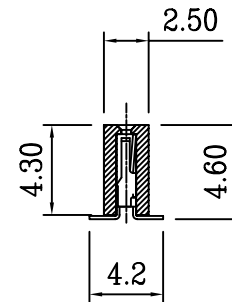
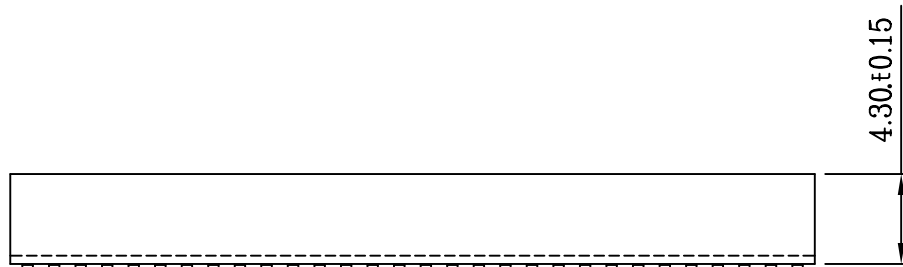
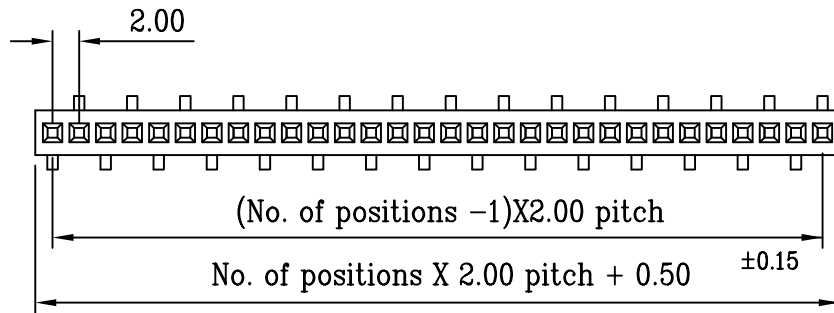

PCB LAYOUT

RoHS Compliant

TOLERANCES ARE

MORETHANALL
PCB CONNECTORS
Cable ASSEMBLIES

DRAWING BY CY

X.±

CHECKED BY GENIUS

.X±

UNIT / mm

SCALE 1:1

.XX±

DATE

.XXX±

ANG±

SIZE A4

PPOJECTION

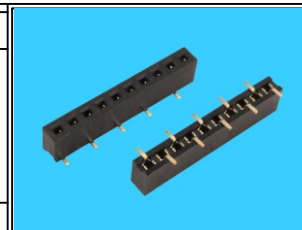

ORDER INFORMATION

S-V46X-1XxxL-LF

SERIES | | | LEADFREE
L TYPE FOOT POSITION

1X02:02WAY
1X40:40WAY

180°SMT | NON POST
HIGH 4.6mm

DESCRIPTION: 2.0mm SMD Socket (Straight/Base:4.5mm)

煜倫股份有限公司

www.morethanall.com