

### Specifications

Current Rating: 2Amp  
 Insulation Resistance: 1000MΩ Min.  
 Dielectric Withstanding: 500V AC/DC  
 Contact Resistance: 20mΩ Max.  
 Operating Temperature: -40°C to +105°C

### Materials

Contact Material: Phosphor Bronze  
 Insulation Material: Polyester, UL 94V-0  
 Nylon-6T

Recommended P.C.Board  
 Hole Layout

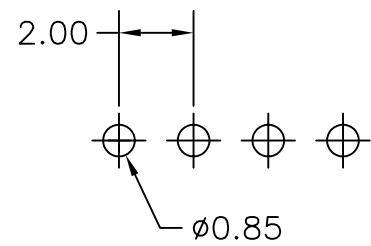

**RoHS Compliant**

TOLERANCES ARE



煜倫股份有限公司

www.morethanall.com

DRAWING BY CY		X. ± .X ± 0.38 .XX ± 0.25 .XXX ± 0.13 ANG ±
CHECKED BY GENIUS		
UNIT / mm	SCALE 1 : 1	
DATE		
SIZE A4	P PROJECTION	



**ORDER INFORMATION**

S-D43-1X02-LF  
 SERIES | LEADFREE  
 | 02WAY  
 | HIGH 4.3mm  
 | DIP 180°

DESCRIPTION: 2.00 FEMALE HEADER 180° DIP TYPE BASE 4.3mm