

RTSW-D-10

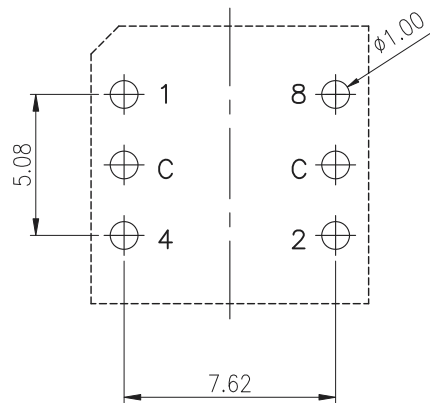
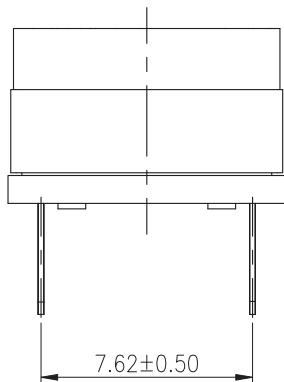
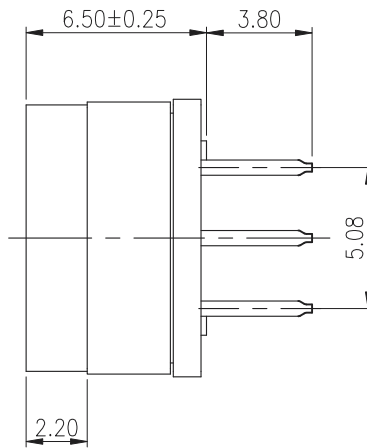

P.C.B. LAYOUT

NOTE:

1.GENERAL TOLERANCES MAX.±0.20mm.

SPECIFICATIONS

- 1.RATING : NON SWITCHING RATING 24VDC 400mA
SWITCHING RATING 24VDC 150mA
- 2.LIFF : 10,000 STEPS
- 3.OPERATING FORCE : 400gf·cm Max.
- 4.INITIAL CONTACT RESISTANCE : 100mOhm Max.
- 5.DIELECTRIC STRENGTH : AC 250V 1 MINUTE
- 6.INSULATION RESISTANCE : 100MOhm Min.
(DC 250V MEGGER)
- 7.OPERATING TEMPERATURE : -60°C TO 125°C

TYPE	CIRCUIT CHARACTERISTICS																
	CODE	POSITION										●ON					
		0	1	2	3	4	5	6	7	8	9	A	B	C	D	E	F
RTSW-D-10	1		●		●		●		●		●						
	2			●	●			●	●								
	4					●	●	●	●								
	8									●	●						

RoHS Compliant

TOLERANCES ARE

MORETHANALL
PCB CONNECTORS
Cable ASSEMBLIES

DRAWING BY CY
CHECKED BY GENIUS
UNIT / mm SCALE 1 : 1
DATE

X.±
.X±
.XX±
.XXX±
ANG ±

照片框

ORDER INFORMATION

RTSW-D-10-LF
SERIES | LEADFREE
10 WAY
DIP 180°

煜倫股份有限公司

www.morethanall.com

SIZE A4

PJECTION

DESCRIPTION: ROTARY SWITCH